

**PROJETO DE ESTRUTURA METÁLICA DA CONSTRUÇÃO DA COBERTURA DA QUADRA ESCALA INDICADA**

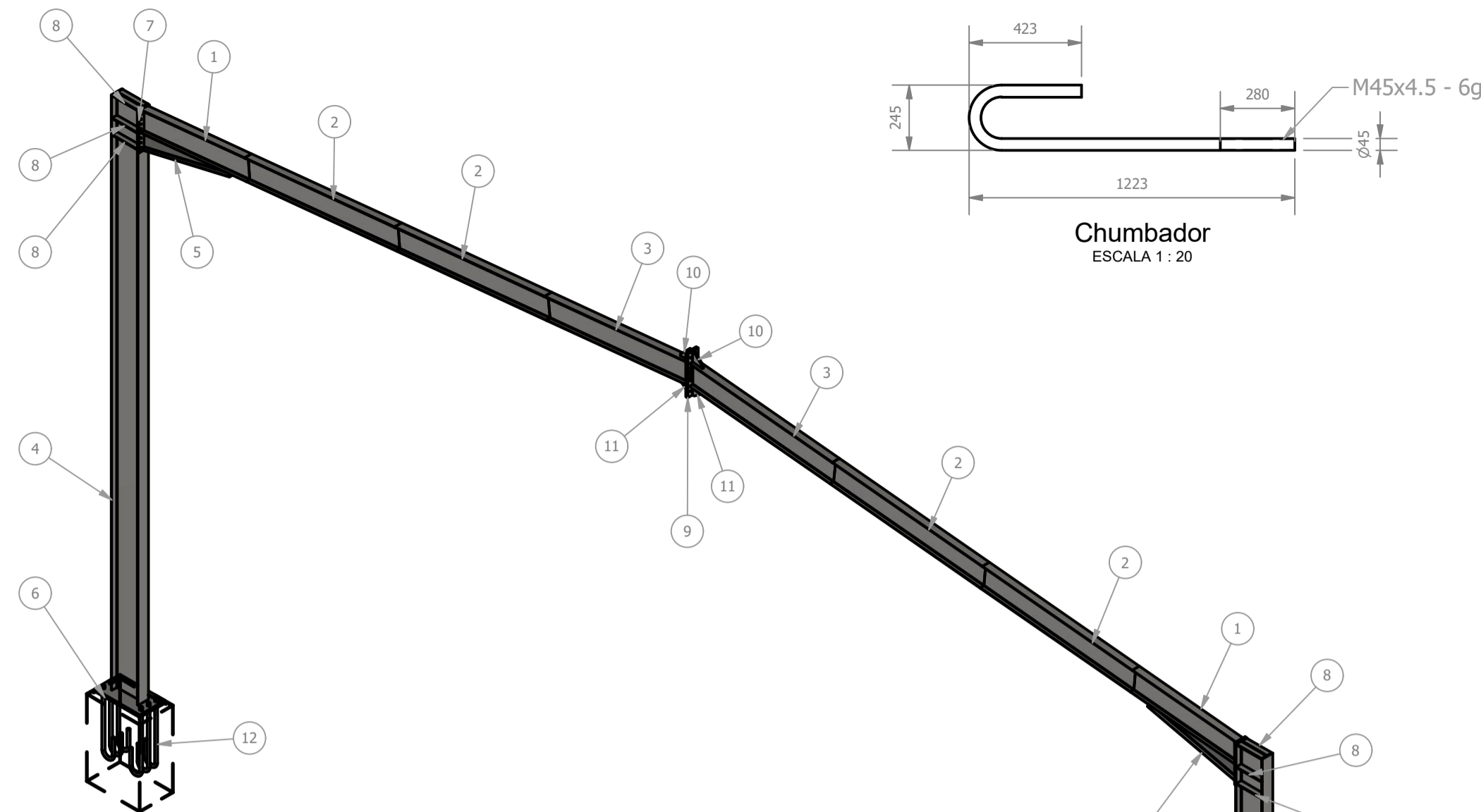

LISTA DE PEÇAS - PÓRTICO						
ID	ITEM	QTD	DESCRIÇÃO	COMPRIM.	MATERIAL	PESO
1	W1	2	W 410 x 38,8	2114	ASTM A36	82,7 kg
2	W2	4	W 410 x 38,8	3000	ASTM A36	118,5 kg
3	W3	2	W 410 x 38,8	2855	ASTM A36	112 kg
4	W4	2	W 530 x 92,0	10256	ASTM A36	946,7 kg
5	W5	2	W 410 x 38,8	1814	ASTM A36	32,5 kg
6	Ch1	2	500 x 900 x 51		ASTM A36	176,1 kg
7	Ch2	2	209 x 722 x 22		ASTM A36	25,4 kg
8	Ch4	12	99 x 502 x 12,5		ASTM A36	4,9 kg
9	Ch5	2	209 x 757 x 22		ASTM A36	26,6 kg
10	Ch6	2	182 x 197 x 25		ASTM A36	4,6 kg
11	Ch7	2	175 x 204 x 22		ASTM A36	3,9 kg
12	Chumbador	12	Ø 45	1550	ASTM A36	21,4 kg

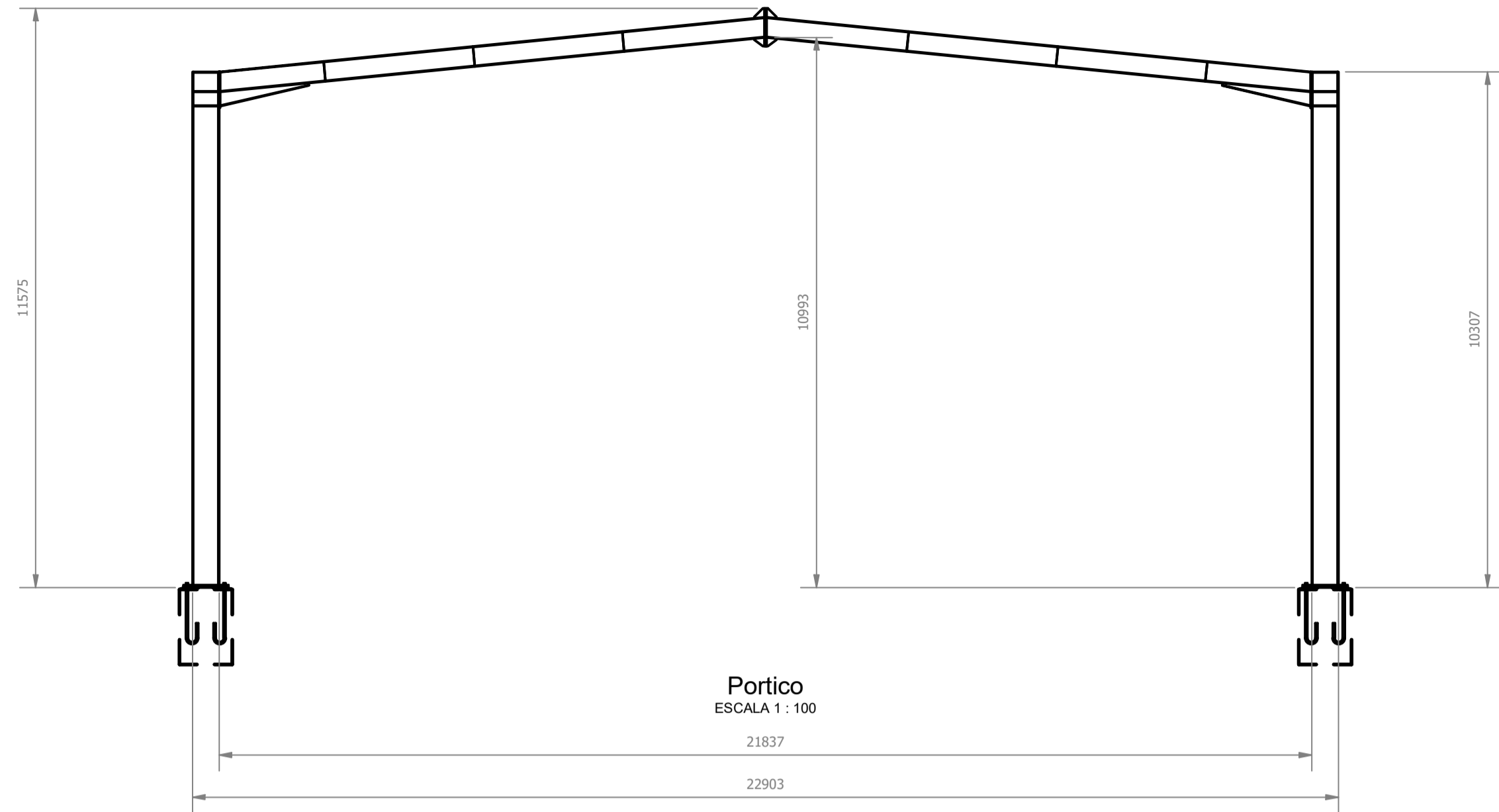
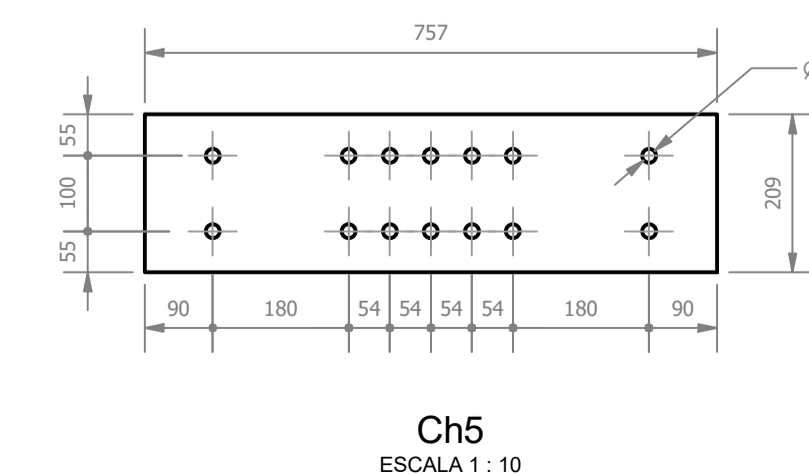
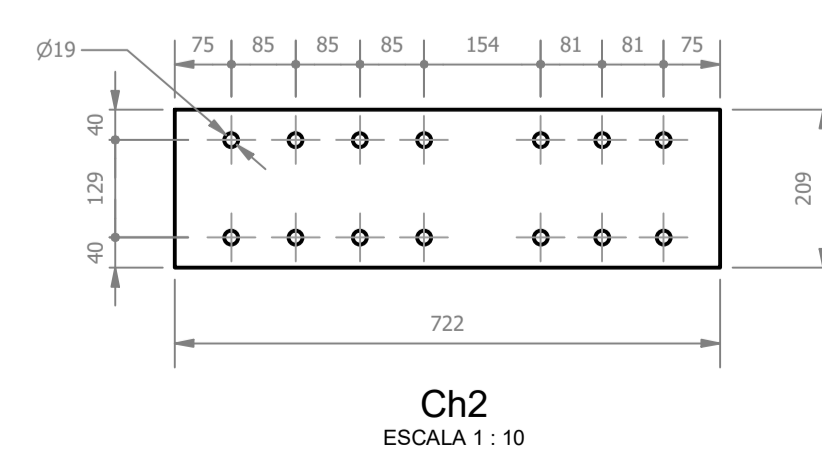
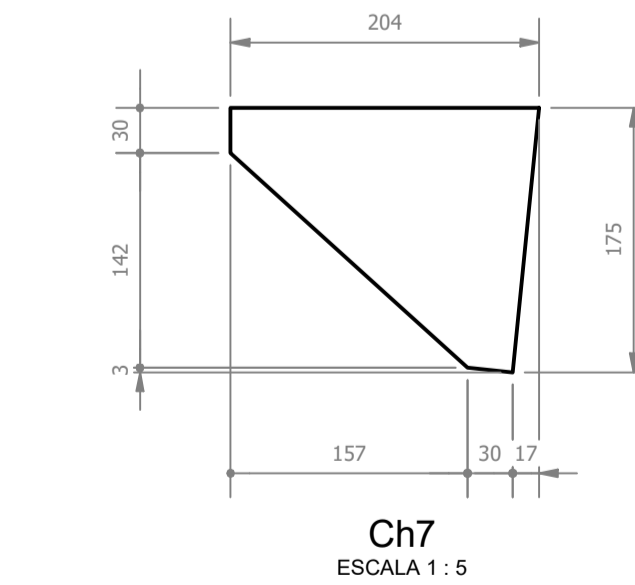
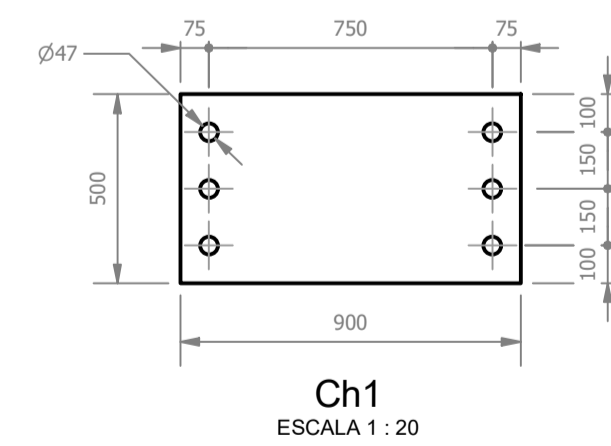
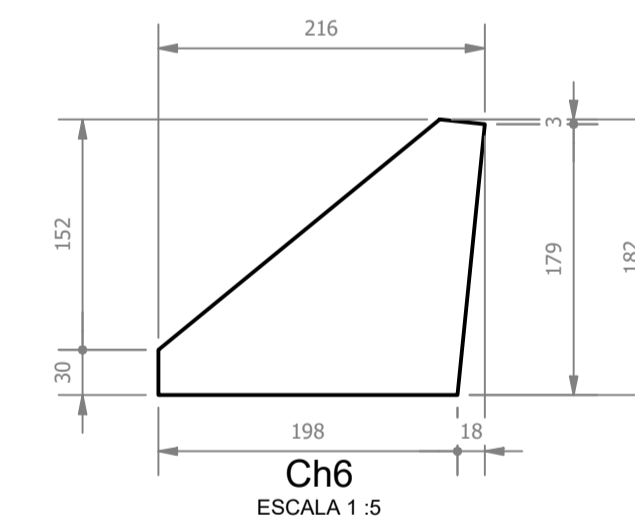
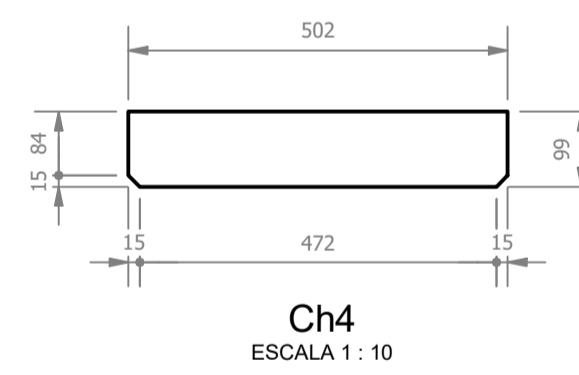
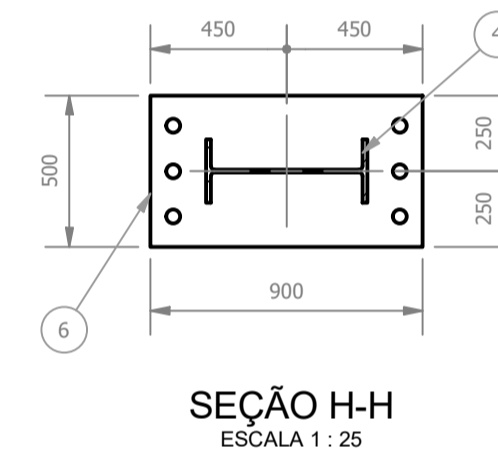
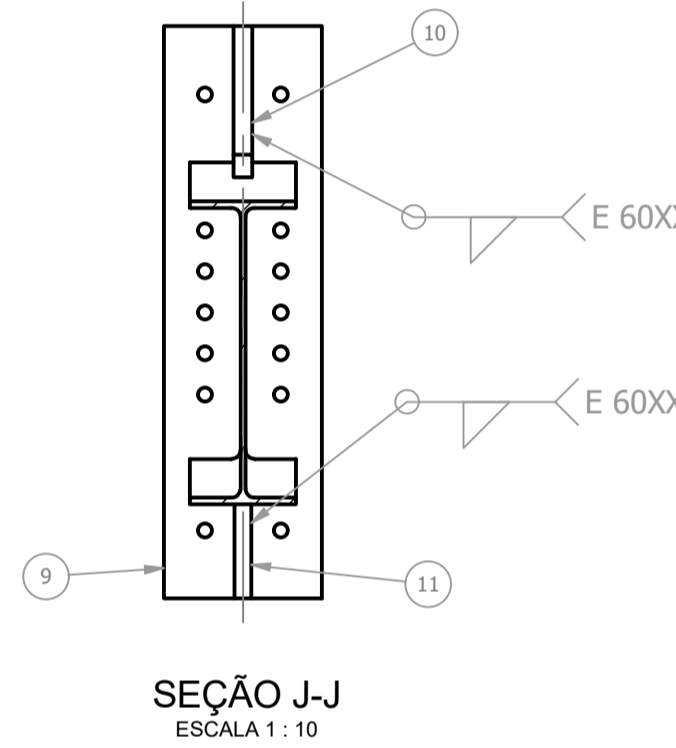
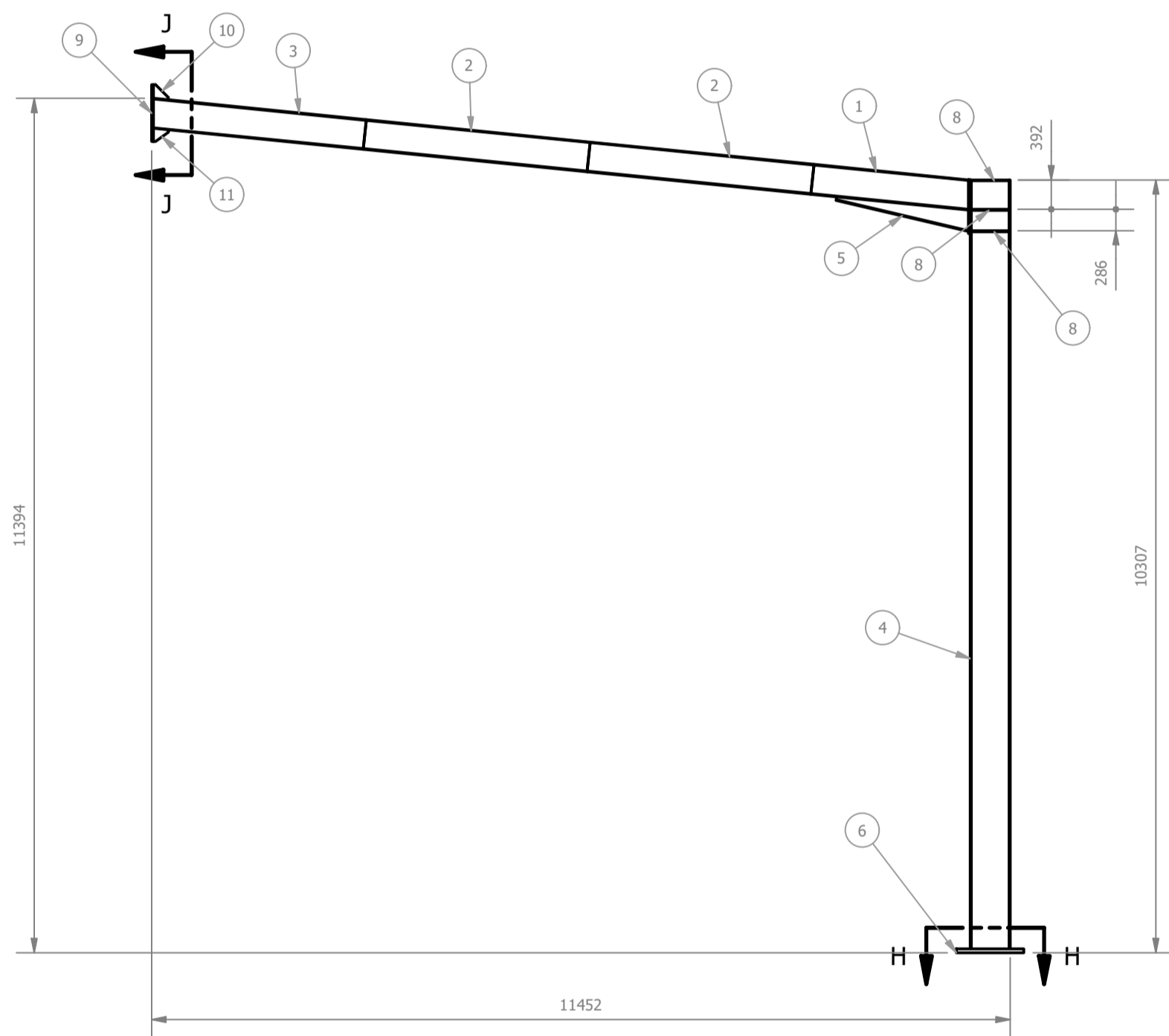

LISTA DE PEÇAS - PILAR LATERAL						
ID	ITEM	QTD	DESCRIÇÃO	COMPRIM.	MATERIAL	PESO
1	W1	1	W 250 x 32,7	10958	Genérico	46 kg
2	Ch9	1	32 x 350 x 500		ASTM A36	43,4 kg
3	Chumbador2	4	BR 1/2"	1500	ASTM A36	4,3 kg

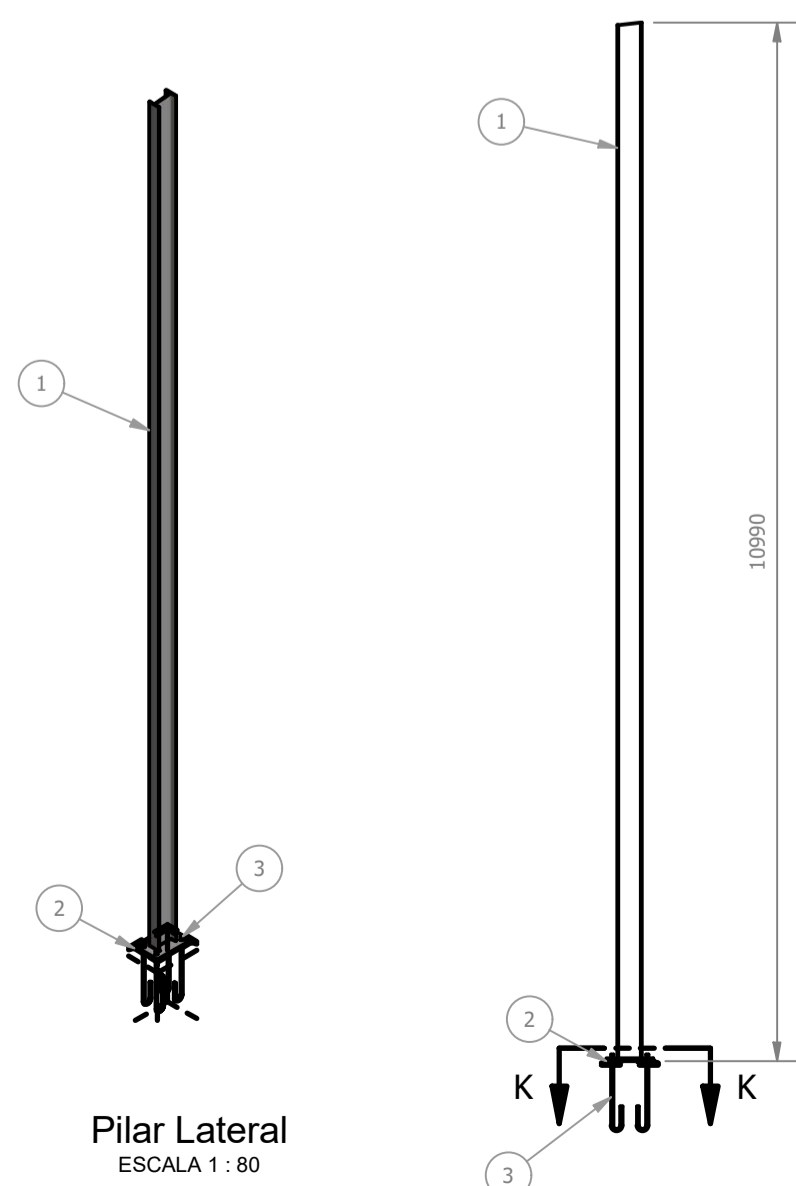
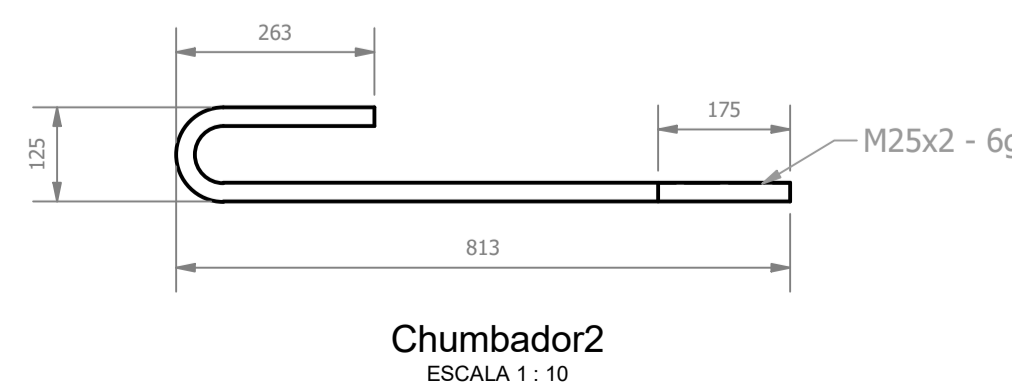
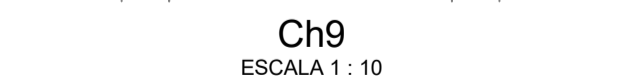
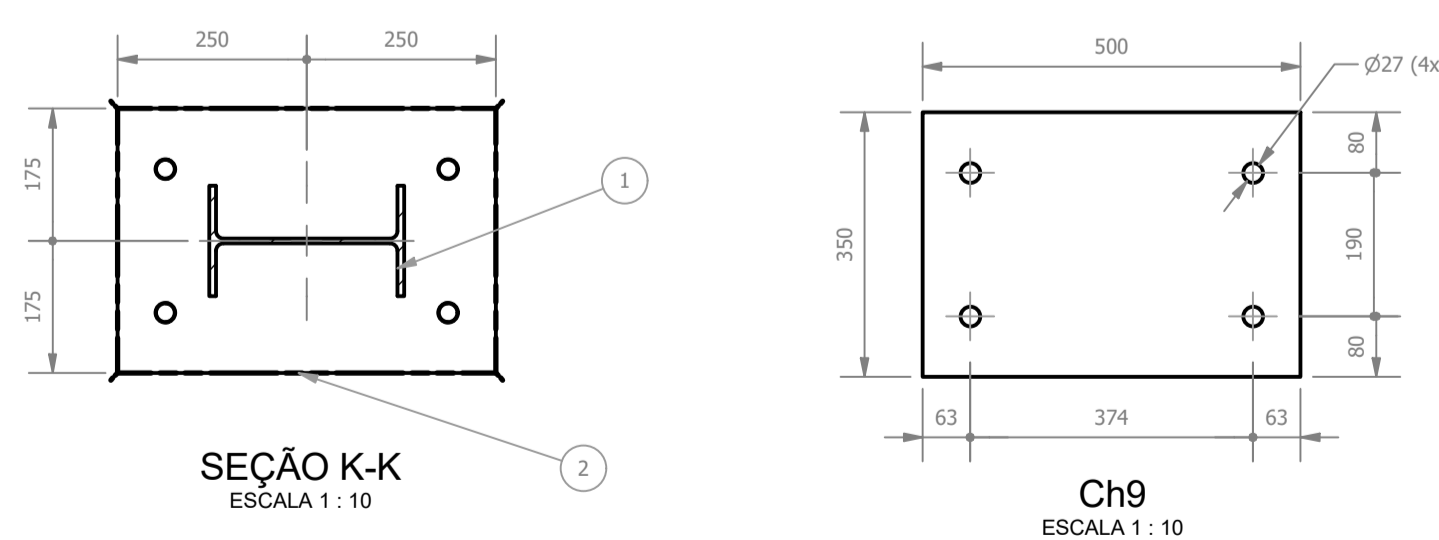

REV. 00	11/03/22	EMISSÃO INICIAL	DAC
REVISÃO	DATA	DESCRIÇÃO	RESP.
<p>Prefeitura Municipal de Pouso Alegre</p>			
<p>DAC Engenharia</p> <p>Rua Miguel Vianna, nº 81, sala 12 Bairro Morro Chic CEP: 37500-080 - Itajubá / MG Tel: (35) 3623-5720 www.dacengenharia.com.br</p>		COORDENAÇÃO ALOISIO CAETANO FERREIRA  RESPONSÁVEL TÉCNICO E AUTOR  ENGª CIVIL FLÁVIA C. BARBOSA    CREA-MG-187.842/D	
EMPREENDIMENTO <b>CONSTRUÇÃO DE COBERTURA DA QUADRA COLINA SANTA BÁRBARA</b>			
ENDEREÇO AV. MARIA DE PAIVA GARCIA, B. COLINA DE STA. BÁRBARA POUSO ALEGRE - MINAS GERAIS		DISCIPLINA <b>METÁLICA</b> FASE DO PROJETO <b>EXECUTIVO</b> FOLHA Nº: <b>2/2</b>	
DATA INICIAL	ESCALA	REVISÃO	ARQUIVO
11/03/2022	INDICADA	R00	DAC-PMPA-QSB-PE-MET-R00.dwg