

PROJETO GEOMÉTRICO - PERFIL LONGITUDINAL  
 ESCALA HORIZONTAL 1:1000  
 ESCALA VERTICAL 1:100

PERFIL ROTATÓRIA 01 - BD INTERNO

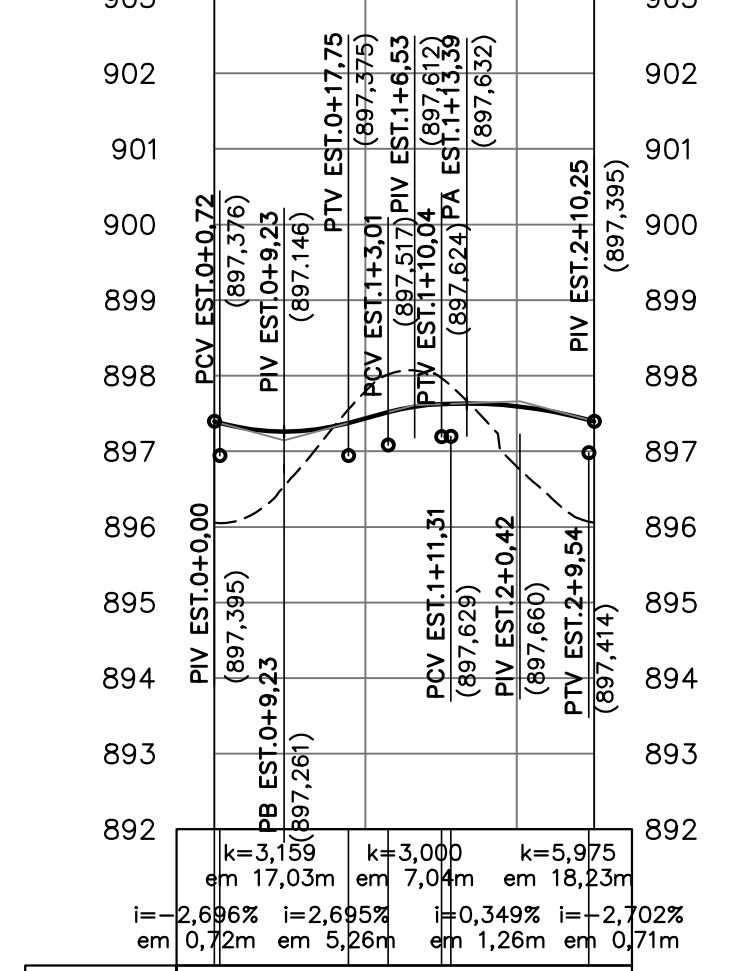

TERRENO	PROJETO	ESTACAS
896,06	897,39	+0.
897,80	897,44	+1.
896,06	897,60	+2.
896,06	897,39	+10,25

PERFIL ROT 01 - RAMO 100

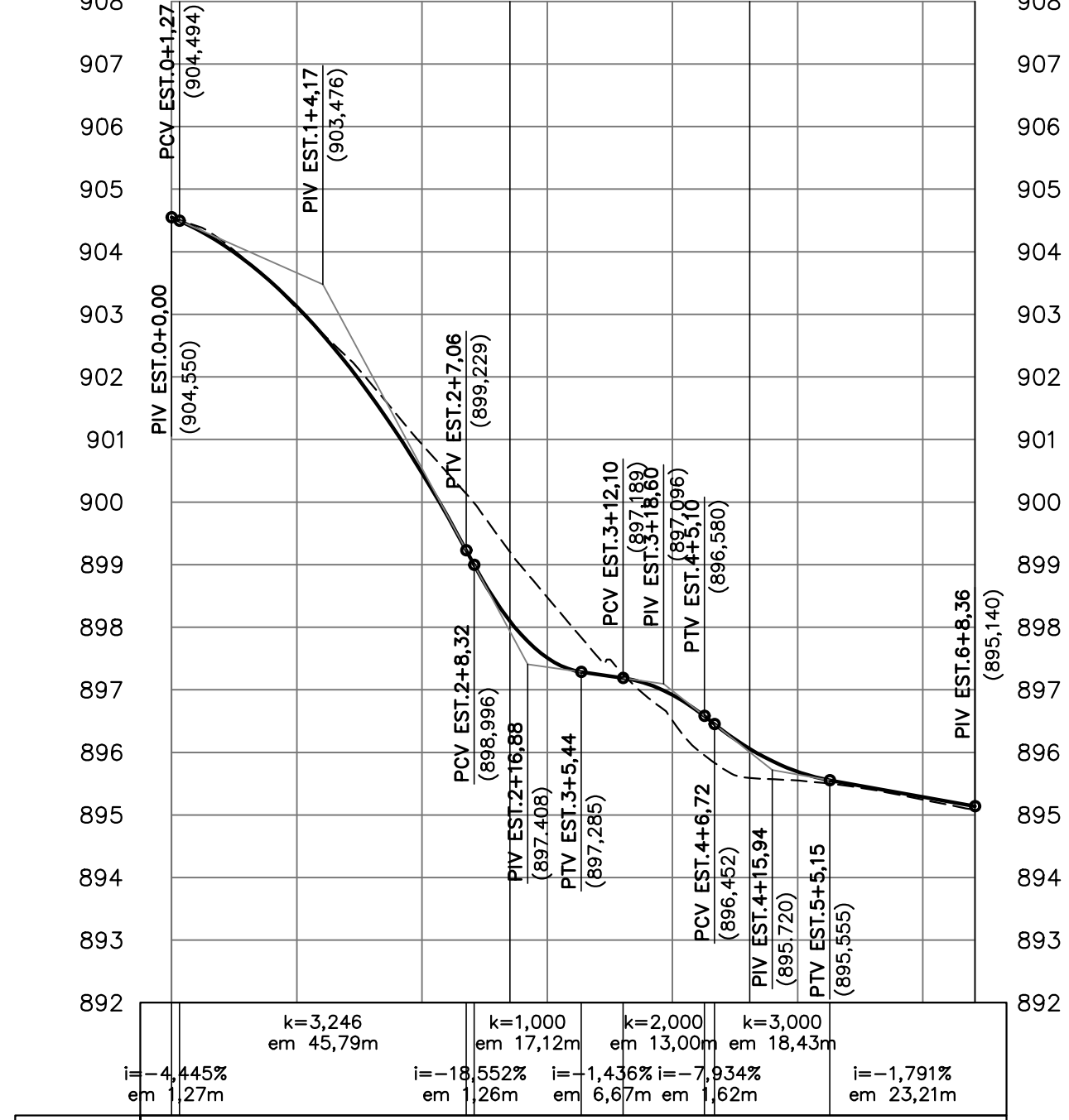

TERRENO	PROJETO	ESTACAS
904,55	904,55	+0.
903,10	903,12	+1.
896,92	900,46	+2.
896,46	897,51	+3.
896,51	896,92	+4.
896,55	896,69	+5.
896,24	896,29	+6.
895,09	895,14	+6+8,36

PERFIL ROT 01 - RAMO 200

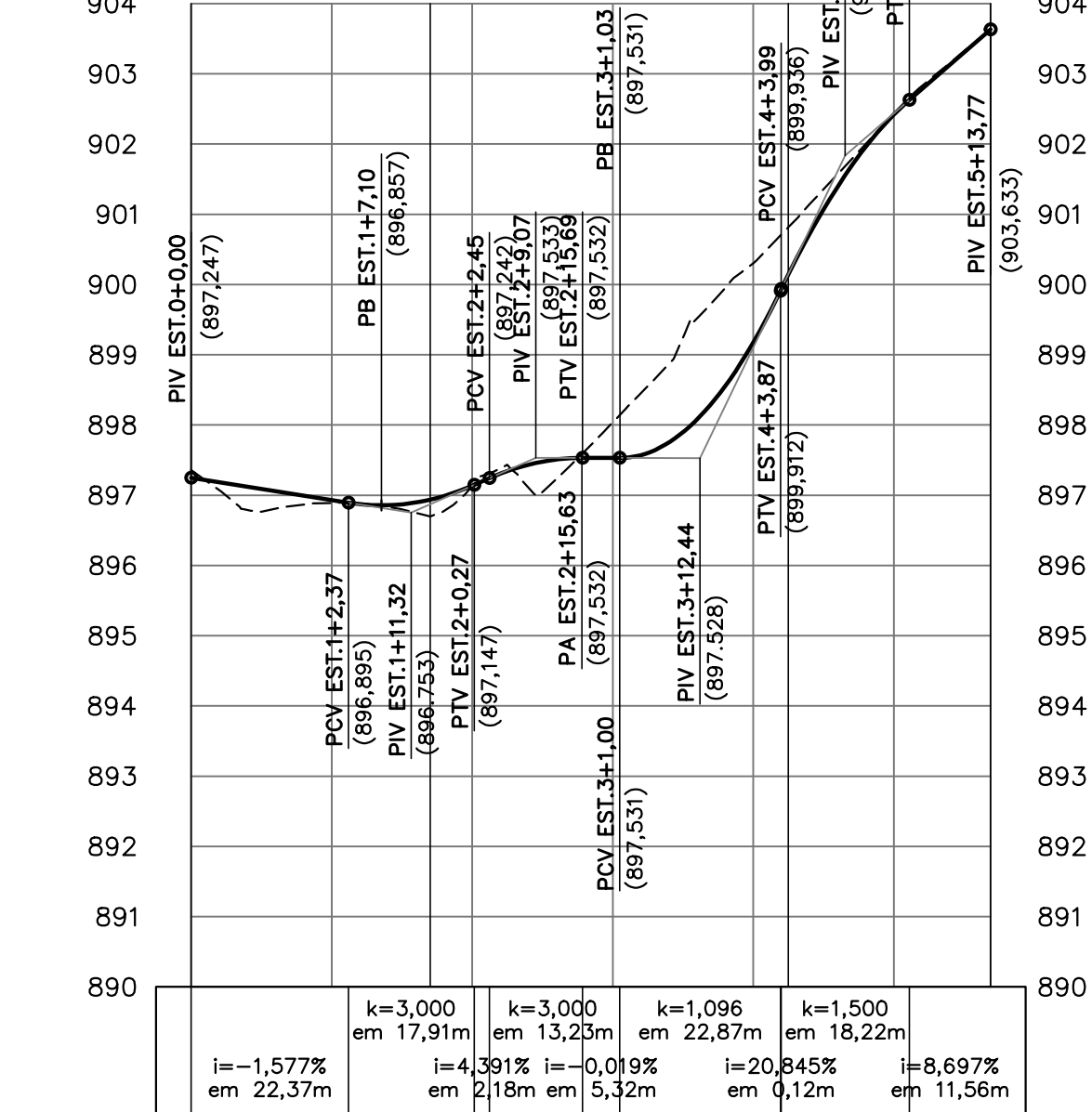

TERRENO	PROJETO	ESTACAS
900,36	897,25	+0.
896,88	896,93	+1.
897,13	897,13	+2.
896,04	897,53	+3.
900,30	899,17	+4.
902,43	902,42	+5.
903,63	903,63	+5+13,77

PERFIL ROT 01 - RAMO 300

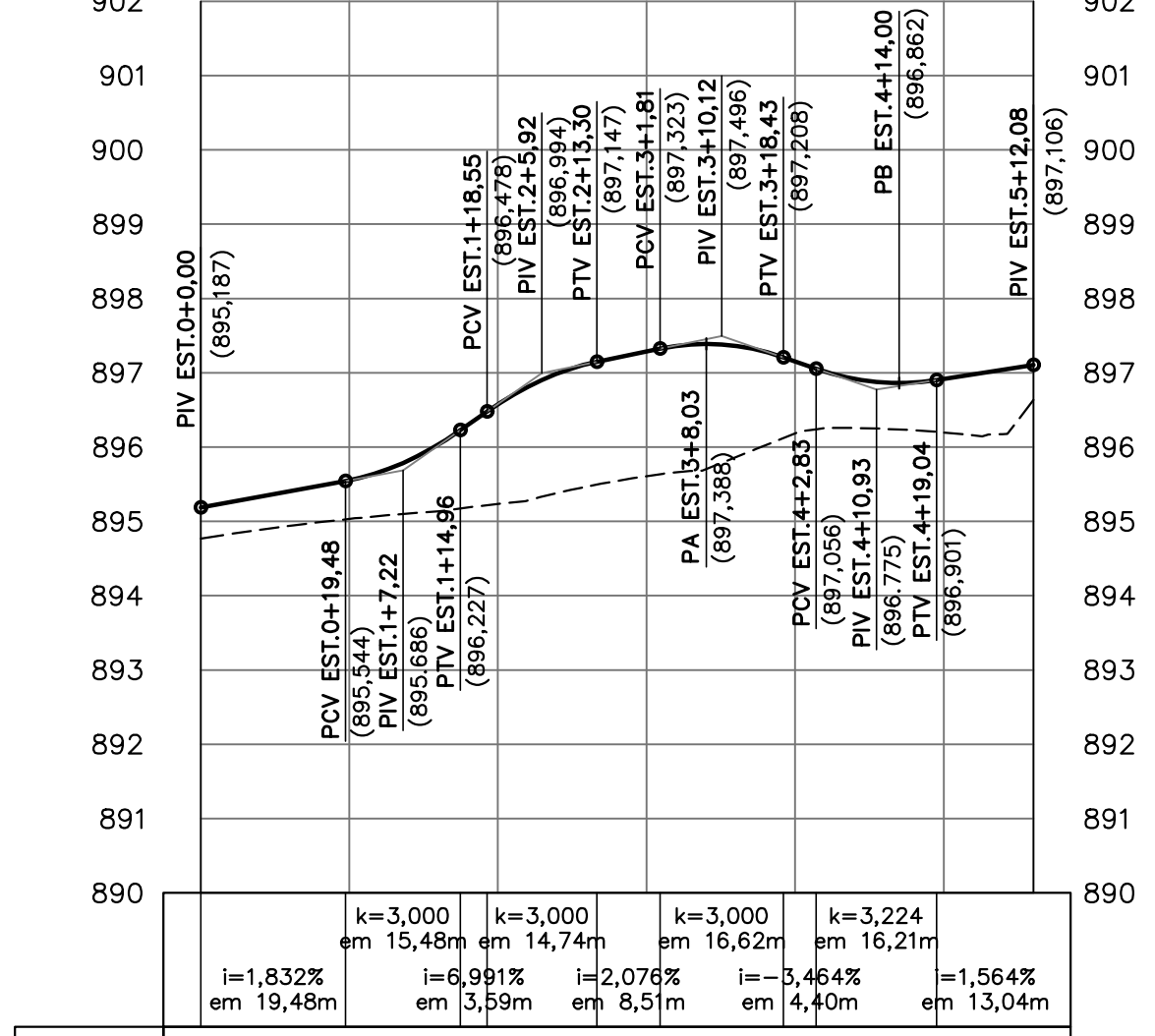

TERRENO	PROJETO	ESTACAS
894,77	895,19	+0.
895,03	895,55	+1.
895,23	896,58	+2.
895,61	897,29	+3.
896,19	897,15	+4.
896,20	896,92	+5.
896,63	897,11	+5+12,08

Nº	DEFLEXÃO/AZIMUTE	TT (m)	R (m)	D/L (m)	AC	TE-PC	ET-PT	PONTO	PI	TE-PC	ET-PT
C22	-	16,000	8,000	50,250	359° 53' 22,08"	0+0,000	2+10,250	N E	7.532.840,5865 405.675,1767	7.532.840,5942 405.675,1758	7.532.840,5789 405.675,1777

Nº	DEFLEXÃO/AZIMUTE	TT (m)	R (m)	D/L (m)	AC	TE-PC	ET-PT	PONTO	PI	TE-PC	ET-PT
L26	270° 13' 17,88"	-	-	54,048	-	0+0,000	2+14,048	N E	-	7.532.848,8835 405.755,4204	7.532.849,0926 405.701,3731
C23	-	8,193	27,858	38,313	078° 48' 01,43"	2+14,048	4+12,361	N E	7.532.848,3543 405.678,5023	7.532.849,0926 405.701,3731	7.532.870,8482 405.673,3360
C24	-	0,695	233,500	35,997	008° 49' 57,97"	4+12,361	6+8,358	N E	7.532.888,1549 405.669,0147	7.532.870,8482 405.673,3360	7.532.904,7924 405.662,6565

Nº	DEFLEXÃO/AZIMUTE	TT (m)	R (m)	D/L (m)	AC	TE-PC	ET-PT	PONTO	PI	TE-PC	ET-PT
C25	-	0,579	250,767	34,037	007° 46' 36,38"	0+0,000	1+14,037	N E	7.532.794,4855 405.679,8413	7.532.777,6499 405.677,1807	7.532.811,5263 405.680,1993
C26	-	11,888	35,000	50,964	083° 25' 46,81"	1+14,037	4+5,001	N E	7.532.842,5060 405.683,9010	7.532.811,5263 405.680,1993	7.532.842,3734 405.715,1009
L27	090° 00' 00,00"	-	-	28,766	-	4+5,001	5+13,767	N E	-	7.532.842,3734 405.715,1009	7.532.842,3734 405.743,8667

Nº	DEFLEXÃO/AZIMUTE	TT (m)	R (m)	D/L (m)	AC	TE-PC	ET-PT	PONTO	PI	TE-PC	ET-PT
C27	-	7,115	226,500	112,085	028° 21' 11,16"	0+0,000	5+12,085	N E	7.532.845,2159 405.678,2507	7.532.898,3821 405.657,1113	7.532.788,3885 405.671,6953

PERFIL ROTATÓRIA 02 - BD INTERNO

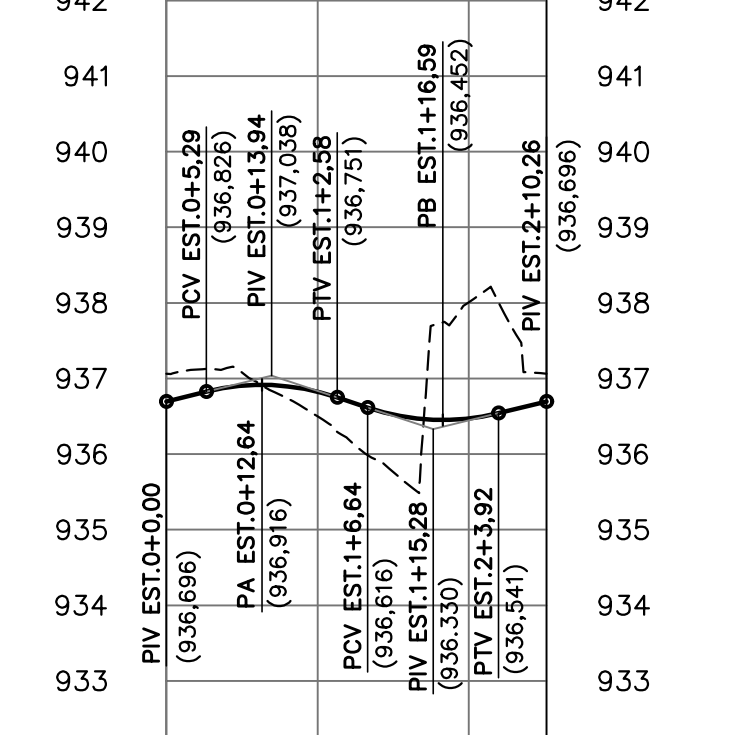

TERRENO	PROJETO	ESTACAS
937,06	936,70	+0.
936,50	936,63	+1.
936,01	936,47	+2.
937,06	936,70	+2+10,26

PERFIL ROT 02 - RAMO 100

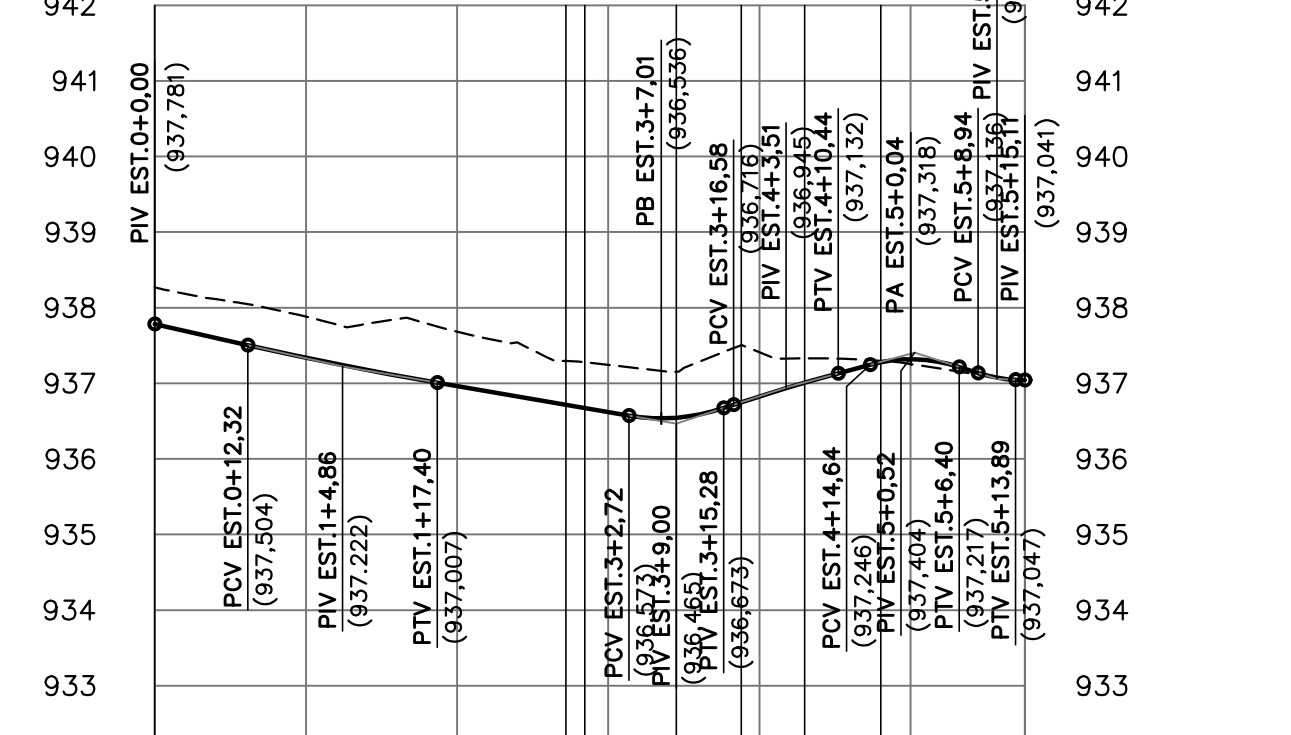

TERRENO	PROJETO	ESTACAS
937,76	936,27	+0.
937,34	937,68	+1.
936,96	937,68	+2.
936,62	937,24	+3.
936,83	937,41	+4.
937,32	937,26	+5.
937,04	937,04	+5+15,11

PERFIL ROT 02 - RAMO 200

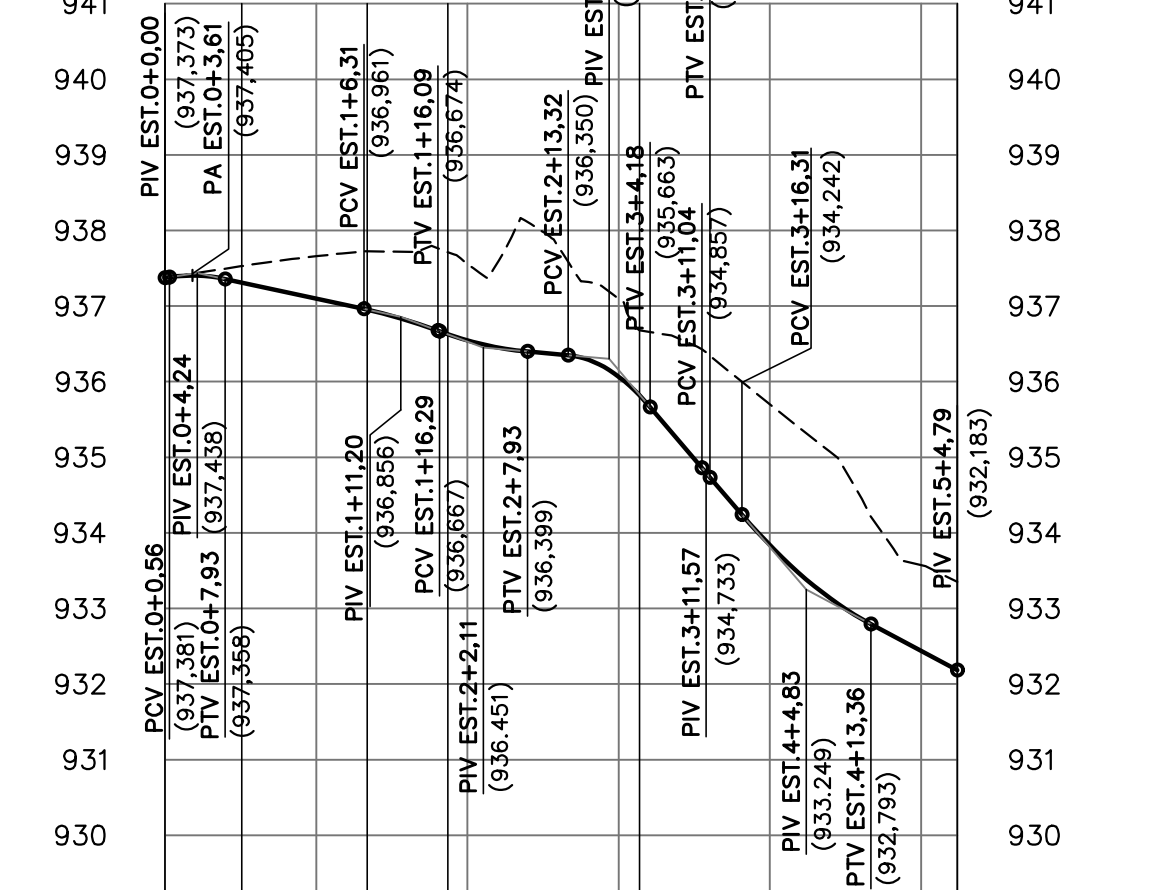

TERRENO	PROJETO	ESTACAS
937,37	937,37	+0.
937,10	937,10	+1.
937,66	937,55	+2.
937,10	937,10	+3.
935,70	933,84	+4.
935,58	932,44	+5+4+7,9

PERFIL ROT 02 - RAMO 300

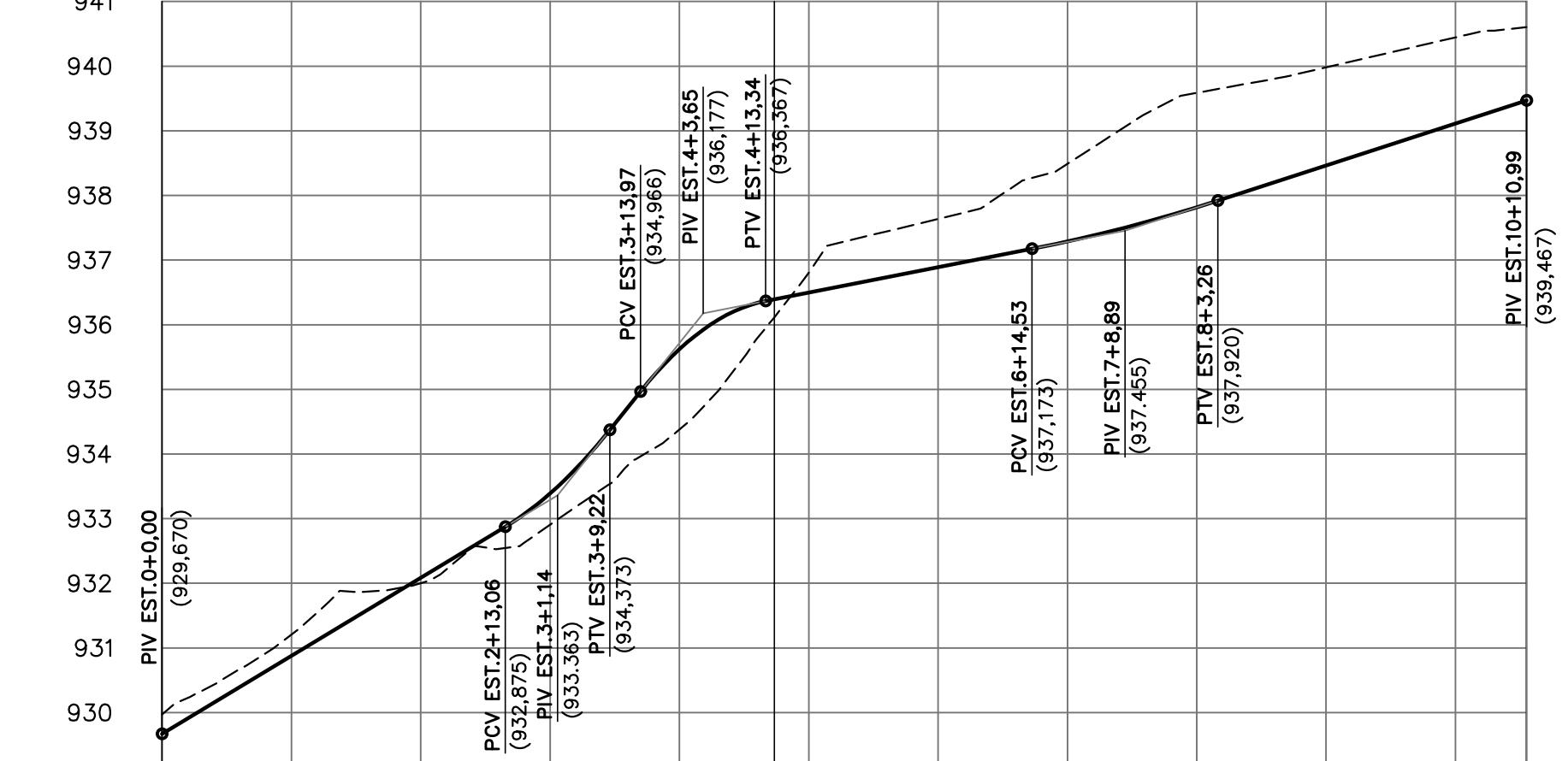

TERRENO	PROJETO	ESTACAS
929,97	929,67	+0.
931,21	930,88	+1.
932,00	932,09	+2.
932,91	933,39	+3.
934,38	935,62	+4.
936,81	936,50	+5.
937,64	936,89	+6.
939,49	937,29	+7.
939,59	937,82	+8.
939,98	938,46	+9.
940,45	939,11	+10.
940,60	939,47	+10+10,99

LEGENDA PERFIL:  
 --- TERRENO NATURAL  
 - - - GREIDE PROJETADO  
 NOTAS:  
 1. COTAS EM METRO, EXCETO ONDE INDICADO;

Nº	DEFLEXÃO/AZIMUTE	TT (m)	R (m)	D/L (m)	AC	TE-PC	ET-PT	PONTO	PI	TE-PC	ET-PT
C28	-	16,000	8,000	50,265	359° 59' 47,45"	0+0,000	2+10,265	N E	7.531.175,7513 404.484.8419	7.531.175,7513 404.484.8422	7.531.175,7513 404.484.8417

Nº	DEFLEXÃO/AZIMUTE	TT (m)	R (m)	D/L (m)	AC	TE-PC	ET-PT	PONTO	PI	TE-PC	ET-PT
C29	-	3,796	100,424	54,377	031° 01' 27,36"	0+0,000	2+14,377	N E	7.531.159,8334 404.493,7891	7.531.156,2247 404.521,4529	7.531.176,8123 404.471,8394
C30	-	0,079	10,000	2,506	014° 21' 39,84"	2+14,377	2+16,884	N E	7.531.177,8067 404.470,8616	7.531.176,8123 404.471,8394	7.531.178,1337 404.469,7173
L28	284° 57' 36,89"	-	-	12,100	-	2+16,884	3+8,984	N E	-	7.531.178,1337 404.469,7173	7.531.183,2398 404.458,7473
C31	-	0,050	183,243	8,995	002° 41' 14,99"	3+8,984	3+17,579	N E	7.531.185,0537 404.454,8504	7.531.183,2398 404.458,7473	7.531.187,0482 404.451,0428
L29	297° 38' 51,68"	-	-	8,380	-	3+17,579	4+5,959	N E	-	7.531.187,0482 404.451,0428	7.531.190,9367 404.443,6199
C32	-	0,127	100,500	10,109	005° 45' 48,04"	4+5,959	4+16,068	N E	7.531.190,9367 404.438,9187	7.531.190,9367 404.443,6199	7.531.196,0698 404.434,9158
L30	303° 24' 39,72"	-	-	19,039	-	4+16,068	5+15,107	N E	-	7.531.206,5533 404.419,0234	7.531.206,5533 404.419,0234

Nº	DEFLEXÃO/AZIMUTE	TT (m)	R (m)	D/L (m)	AC	TE-PC	ET-PT	PONTO	PI	TE-PC	ET-PT
L31	123° 18' 03,90"	-	-	10,141	-	0+0,000	0+10,141	N E	-	7.531.201,7743 404.417,2248	7.531.196,2065 404.425,7006
C33	-	0,213	161,912	16,583	005° 52' 05,97"	0+10,141	1+6,724	N E	7.531.191,8501 404.432,6368	7.531.196,2065 404.425,7006	7.531.187,8267 404.440,0025
L32	117° 25' 57,84"	-	-	10,689	-	1+6,724	1+17,413	N E	-	7.531.187,8267 404.440,0025	7.531.182,8023 404.449,4893
C34	-	35,982	9,300	25,369	156° 17' 48,39"	1+17,413	3+2,782	N E	7.531.162,1635 404.488,1544	7.531.162,2023 404.444,4983	7.531.165,4084 404.444,4983
C35	-	0,881	251,158	42,011	009° 35' 01,70"	3+2,782	5+4,793	N E	7.531.166,8737 404.423,4528	7.531.165,4084 404.444,4983	7.531.164,8217 404.402,4884

Nº	DEFLEXÃO/AZIMUTE	TT (m)	R (m)	D/L (m)	AC	TE-PC	ET-PT	PONTO	PI	TE-PC	ET-PT
C36	-	4,824	246,093	94,675	022° 02' 32,57"	0+0,000	4+14,675	N E	7.531.163,0022 404.409,2279	7.531.160,6280 404.362,9274	7.531.157,1306 404.456,7948
L33	097° 01' 23,00"	-	-	116,315	-	4+14,675	10+10,990	N E	-	7.531.157,1306 404.456,7948	7.531.142,9088 404.572,2389

REV. 00 | 19/11/21 | EMISSÃO INICIAL

REVISÃO: DATA | DESCRIÇÃO:

CLIENTE

DAC

RESP.:

Prefeitura Municipal de Pouso Alegre

<p>PROJETO</p> <p>Rua Miguel Vianna, nº 81, Sala 12                  Bairro Morro Chic                  CEP: 37500-080 - Itajubá / MG                  Tel: (35) 3623-5720                  www.dacengenharia.com.br</p>	<p>GERÊNCIA DE PROJETOS                  FELPE G. ALEXANDRE CREA: MG-245.286/D</p> <p>COORDENAÇÃO DE PROJETOS                  DENIS DE SOUZA SILVA CREA: MG-127.216/D</p> <p>RESPONSÁVEL TÉCNICO                  ENG. FLÁVIA C BARBOSA CREA: MG-187.842/D</p> <p>PROJETO                  PEDRO HENRIQUE JUSTINIANO</p> <p>DESENHO                  ERICA DE SOUSA SILVA</p>
--	--

<p>EMPRESAMENTO</p> <p>OBRAS DE DRENAGEM E PAVIMENTAÇÃO DA VIA DE INTERLIGAÇÃO DO INSTITUTO FEDERAL-PARQUE REAL AO ALGODÃO</p> <p>ENDEREÇO                  ESTRADA MUNICIPAL - BAIRRO ALGODÃO                  POUSO ALEGRE - MINAS GERAIS</p> <p>ASSUNTO                  PROJETO EXECUTIVO DE GEOMETRIA                  PERFS LONGITUDINAIS E TABELAS DE LOCAÇÃO</p>	<p>DISCIPLINA                  GEOMÉTRICO</p> <p>FASE DO PROJETO                  EXECUTIVO</p> <p>FOLHA Nº                  10/10</p>
--	--

DATA INICIAL 19/11/2021	ESCALA 1:1000	REVISÃO ROO	ARQUIVO DAC-PMPA-LIA-PE-GE0-ROO.DWG
----------------------------	------------------	----------------	--