

1 VISTA 1 - I.S COLETA
1:25

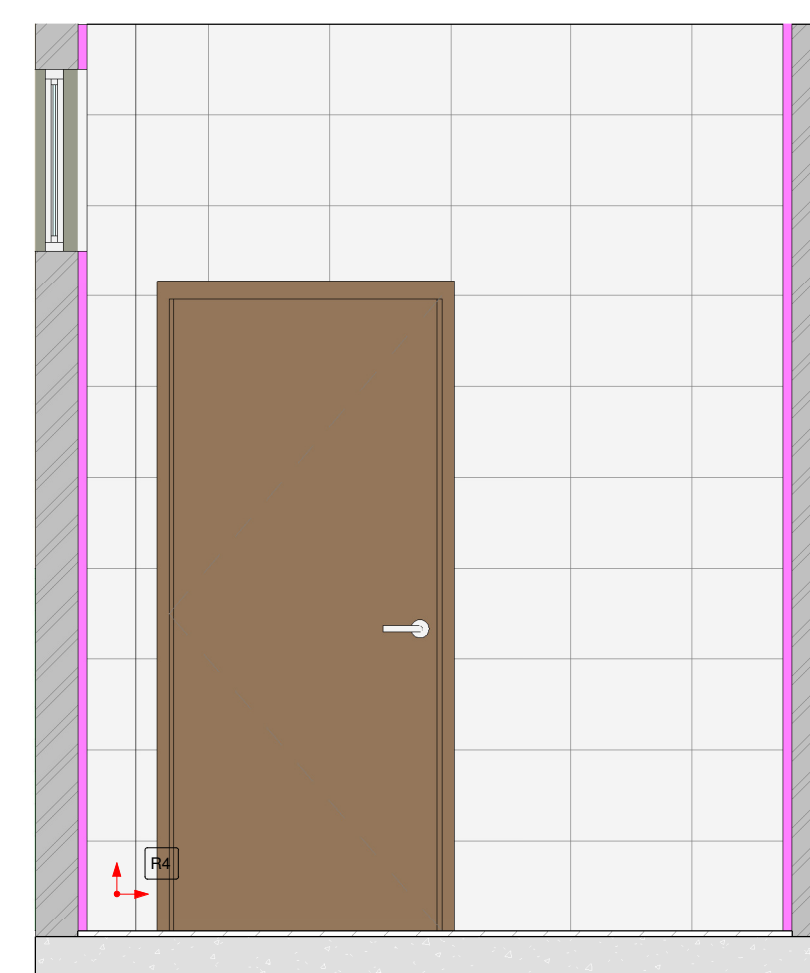

2 VISTA 2 - I.S COLETA
1:25

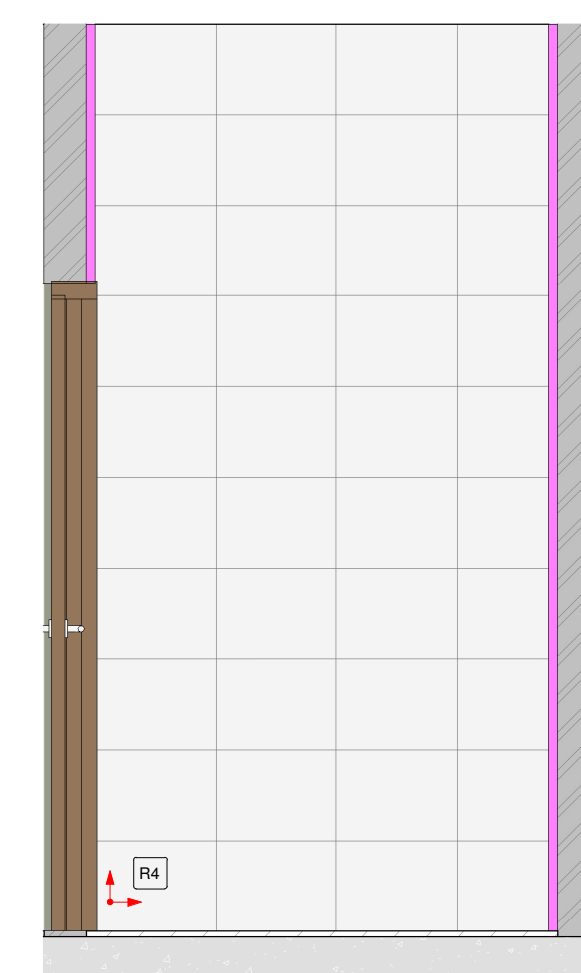

3 VISTA 3 - I.S COLETA
1:25

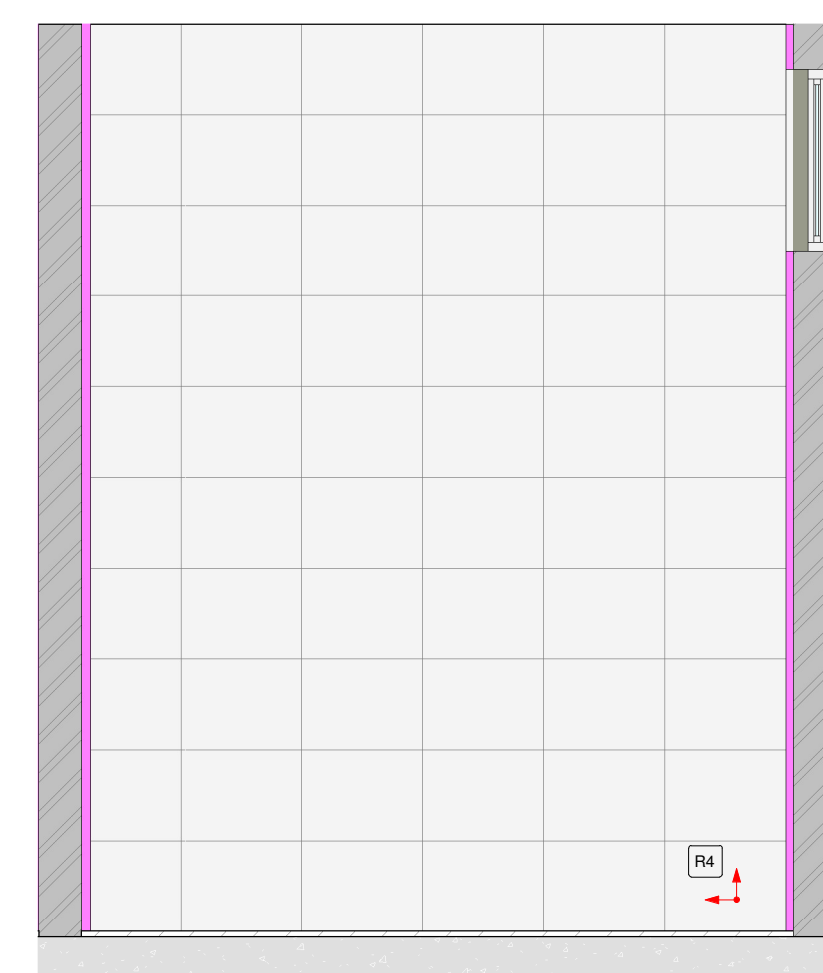

4 VISTA 4 - I.S COLETA
1:25

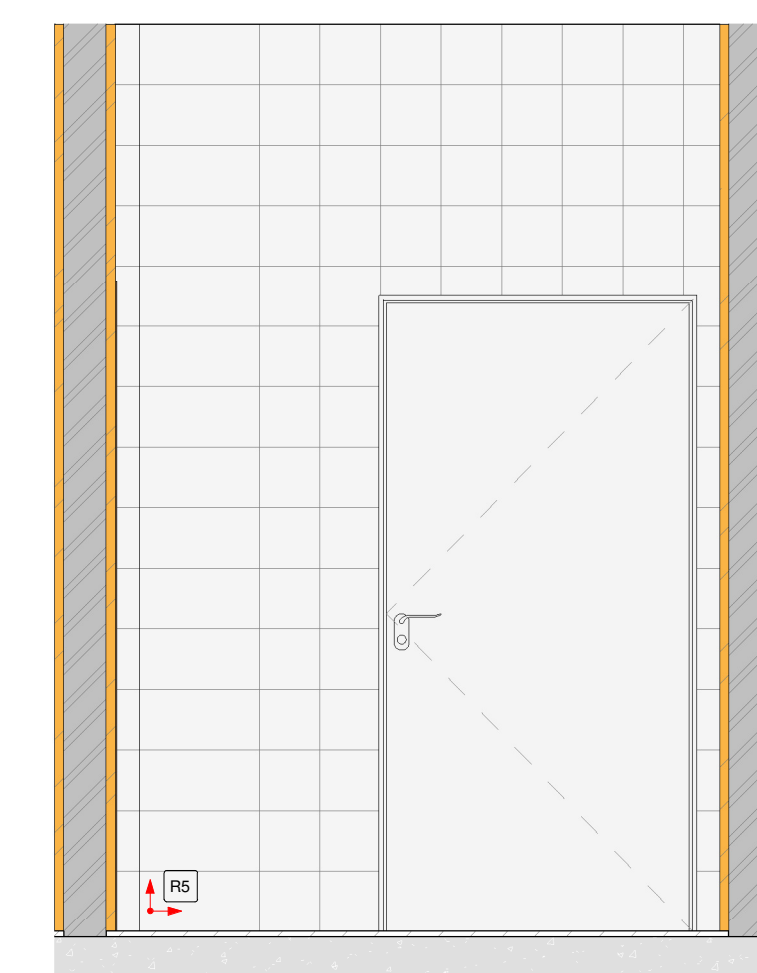

5 VISTA 1 - RECEPÇÃO E LAVAGEM
1:25

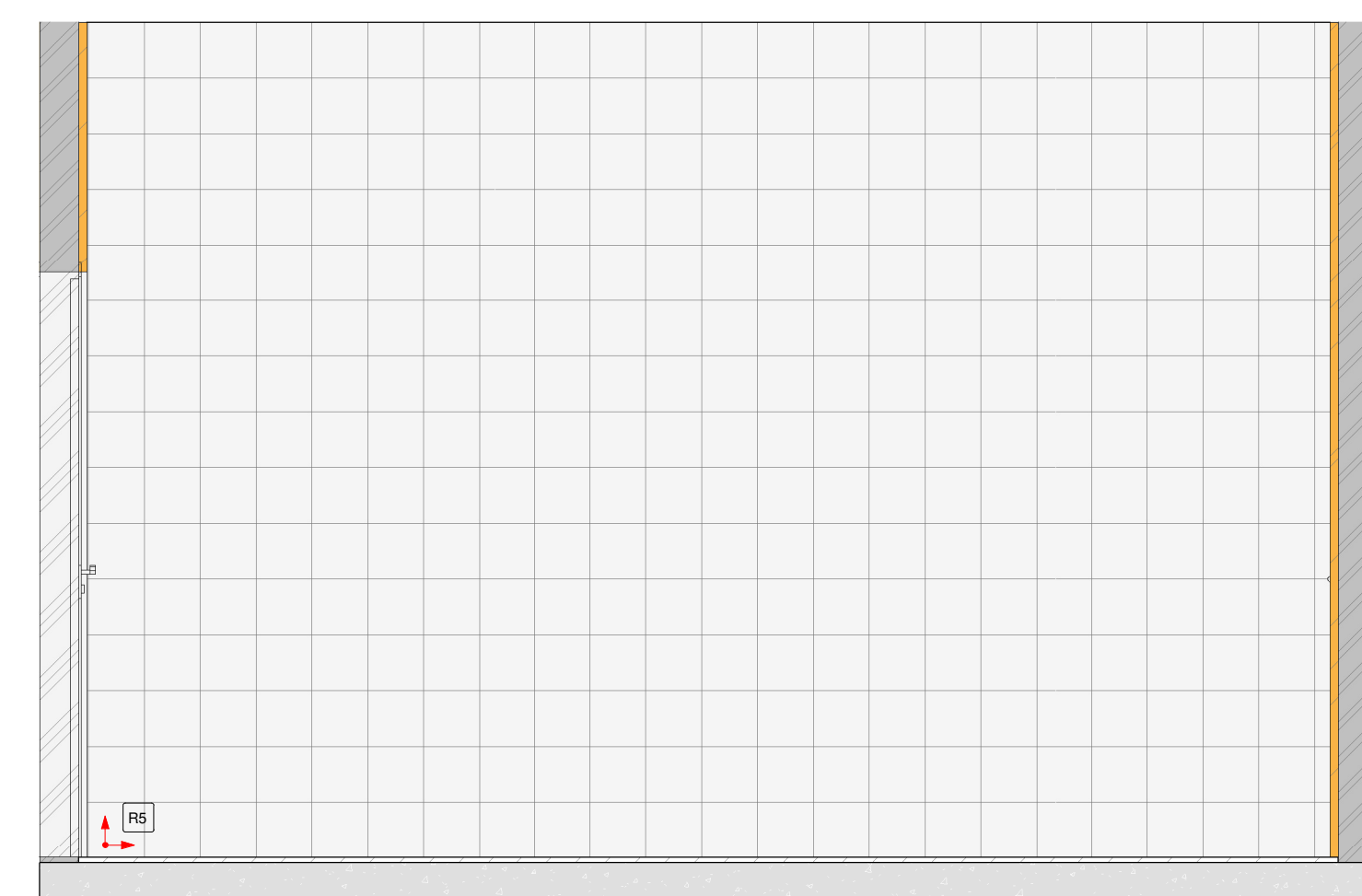

6 VISTA 2 - RECEPÇÃO E LAVAGEM
1:25

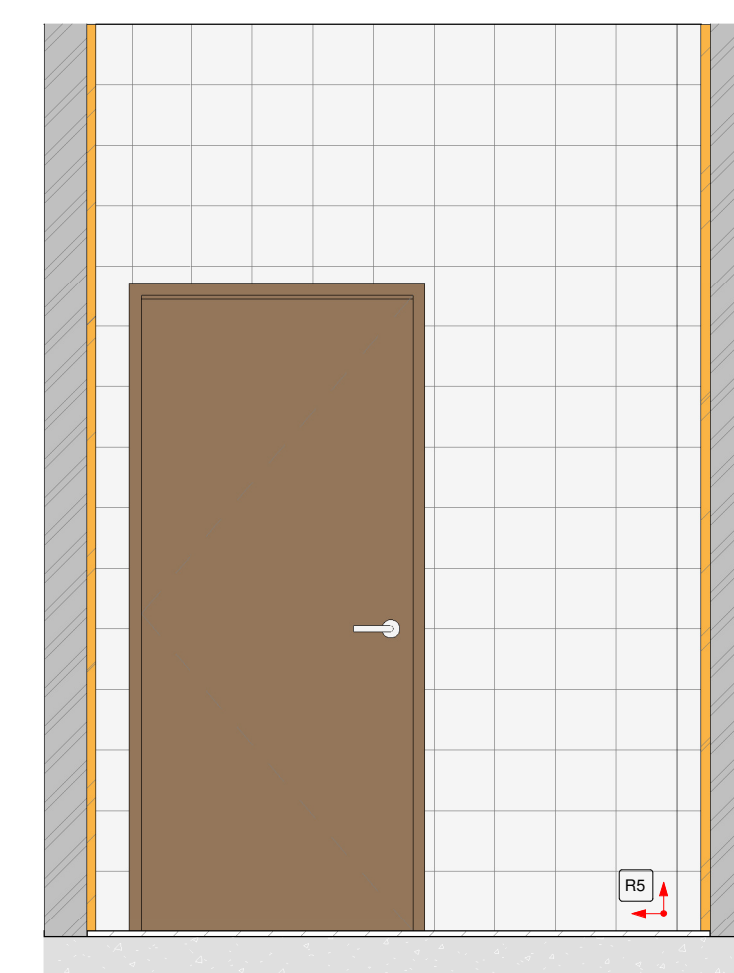

7 VISTA 3 - RECEPÇÃO LAVAGEM
1:25

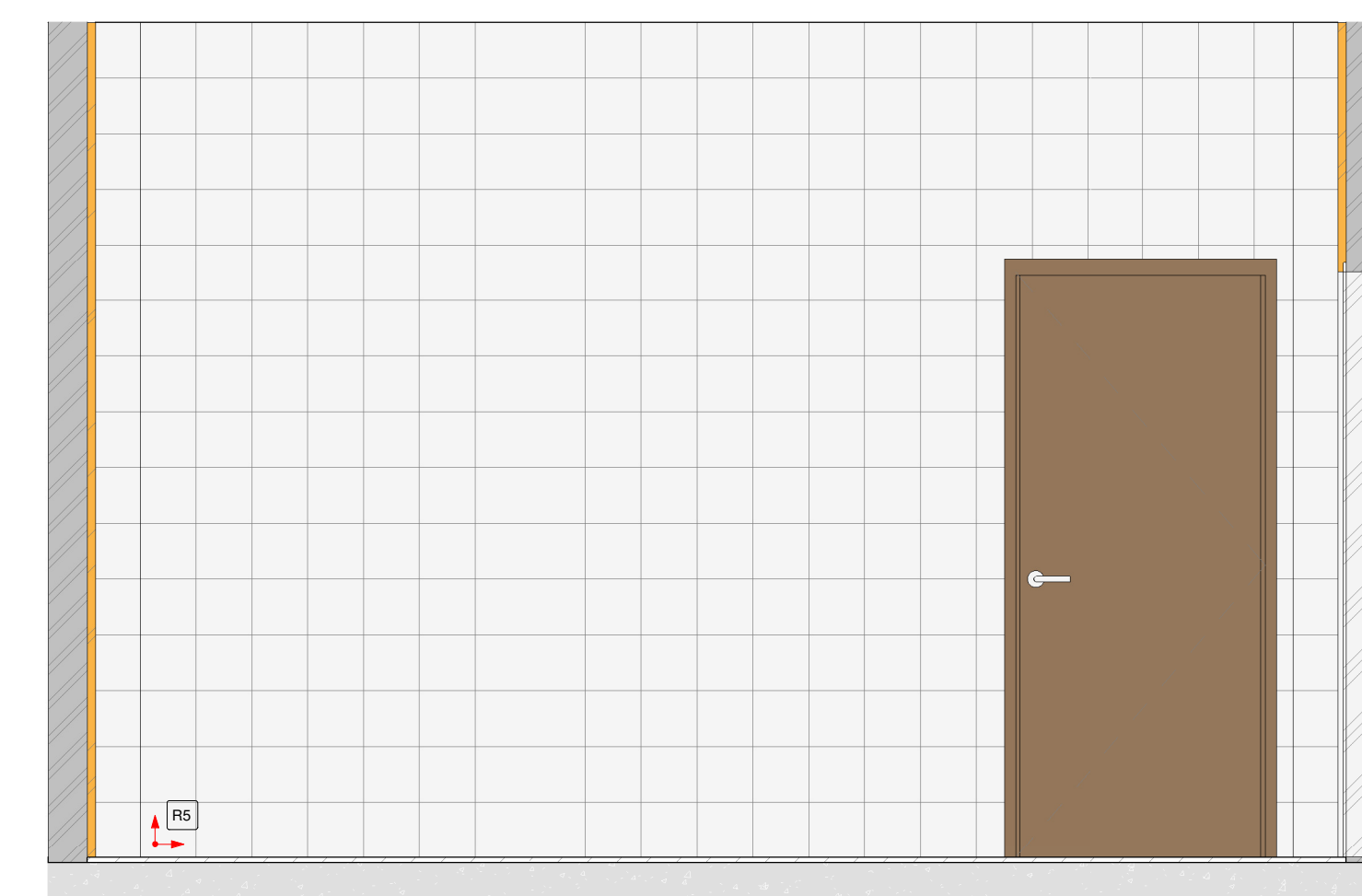

8 VISTA 4 - RECEPÇÃO E LAVAGEM
1:25

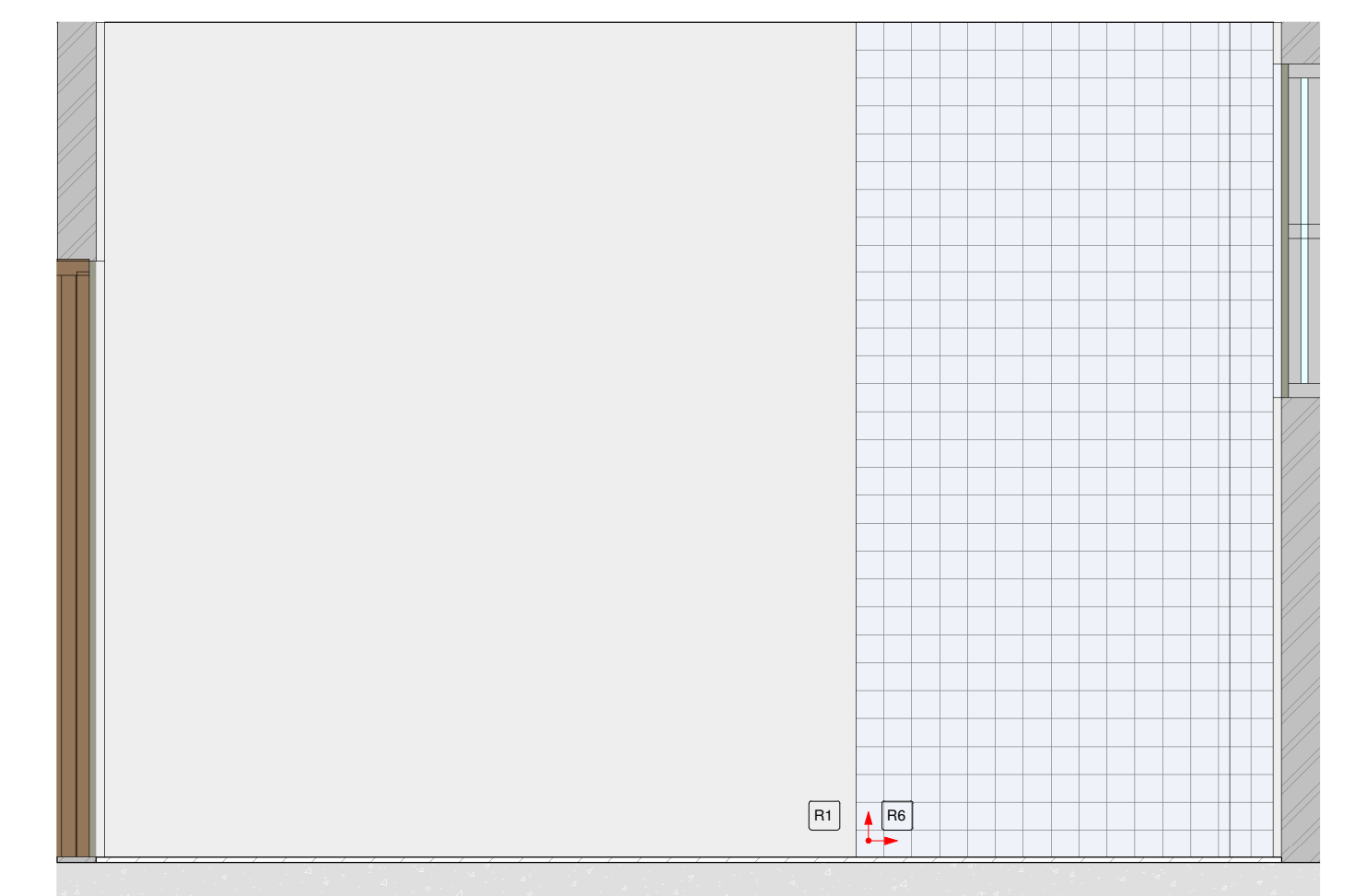

9 VISTA 1 - SALA DE GESSO
1:25

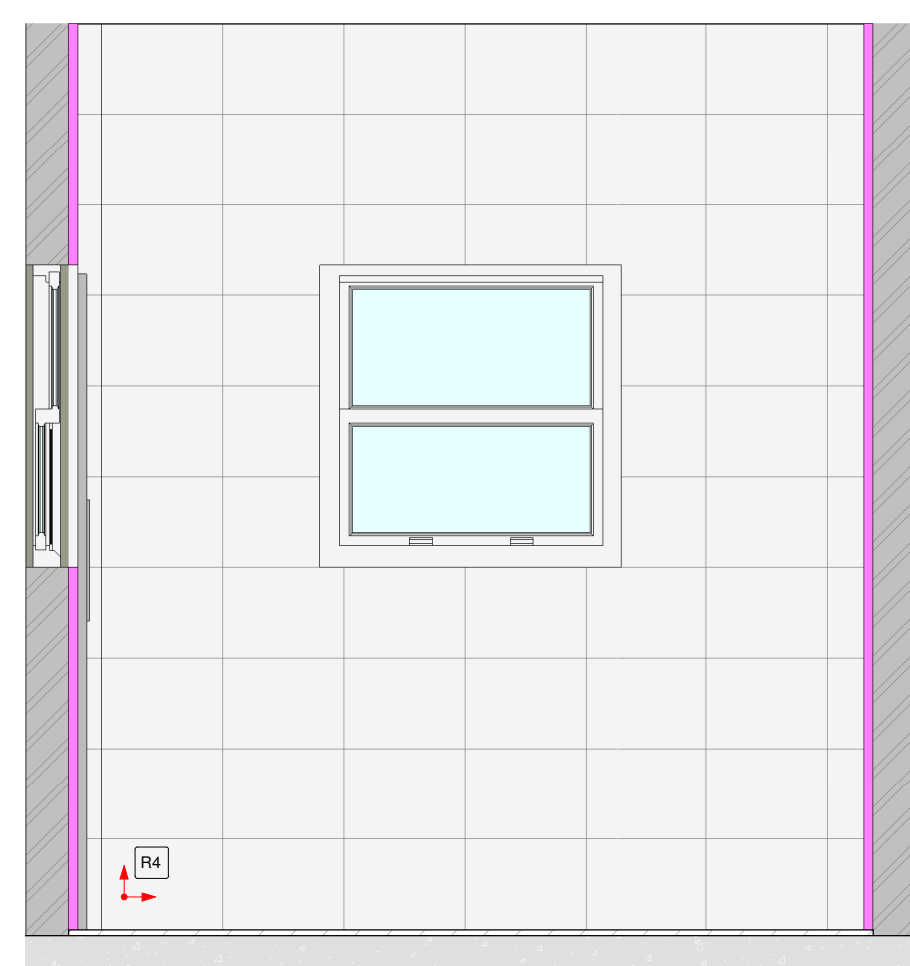

10 VISTA 1 - CENTRAL DE ESTERILIZAÇÃO
1:25

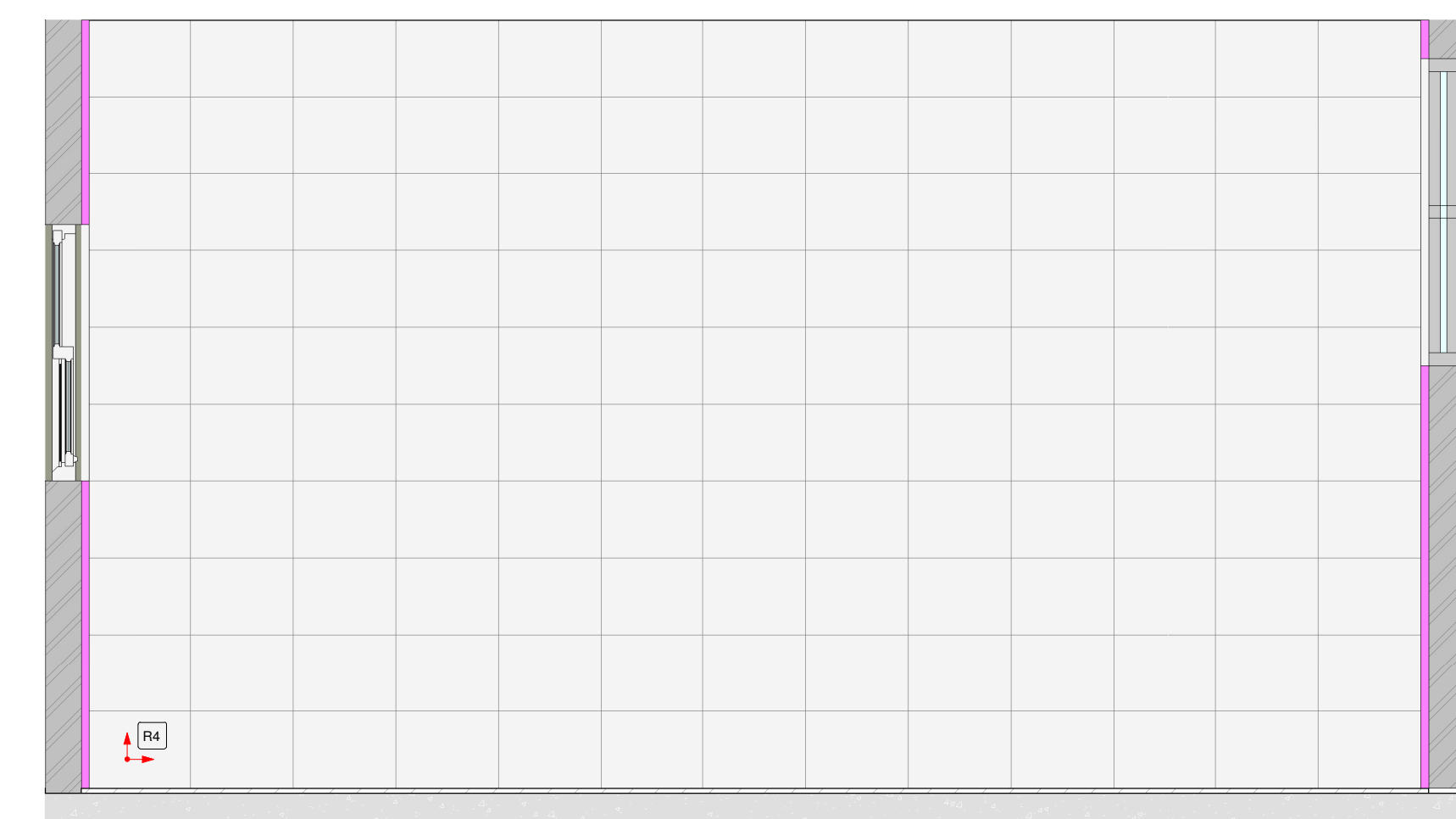

11 VISTA 2 - CENTRAL ESTERILIZAÇÃO
1:25

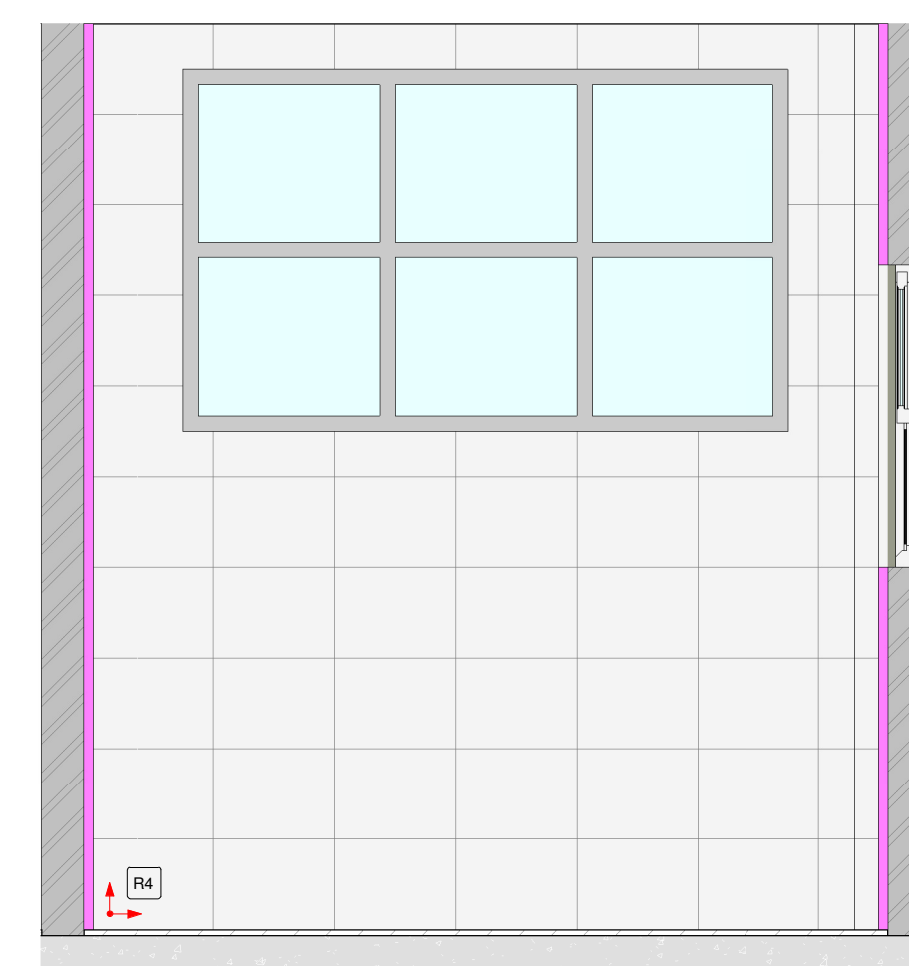

12 VISTA 3 - CENTRAL DE ESTERILIZAÇÃO
1:25

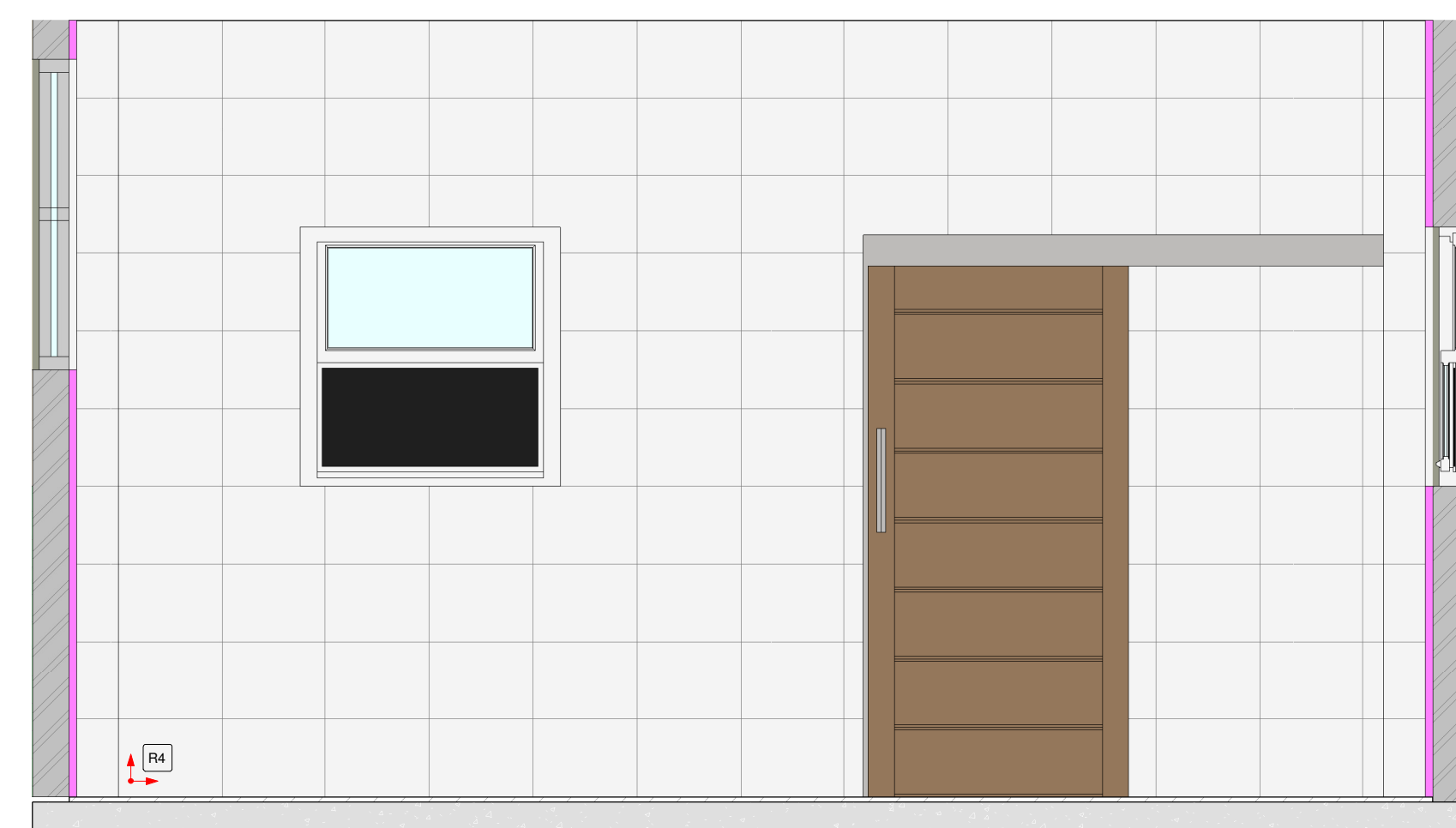

13 VISTA 4 - CENTRAL DE ESTERILIZAÇÃO
1:25

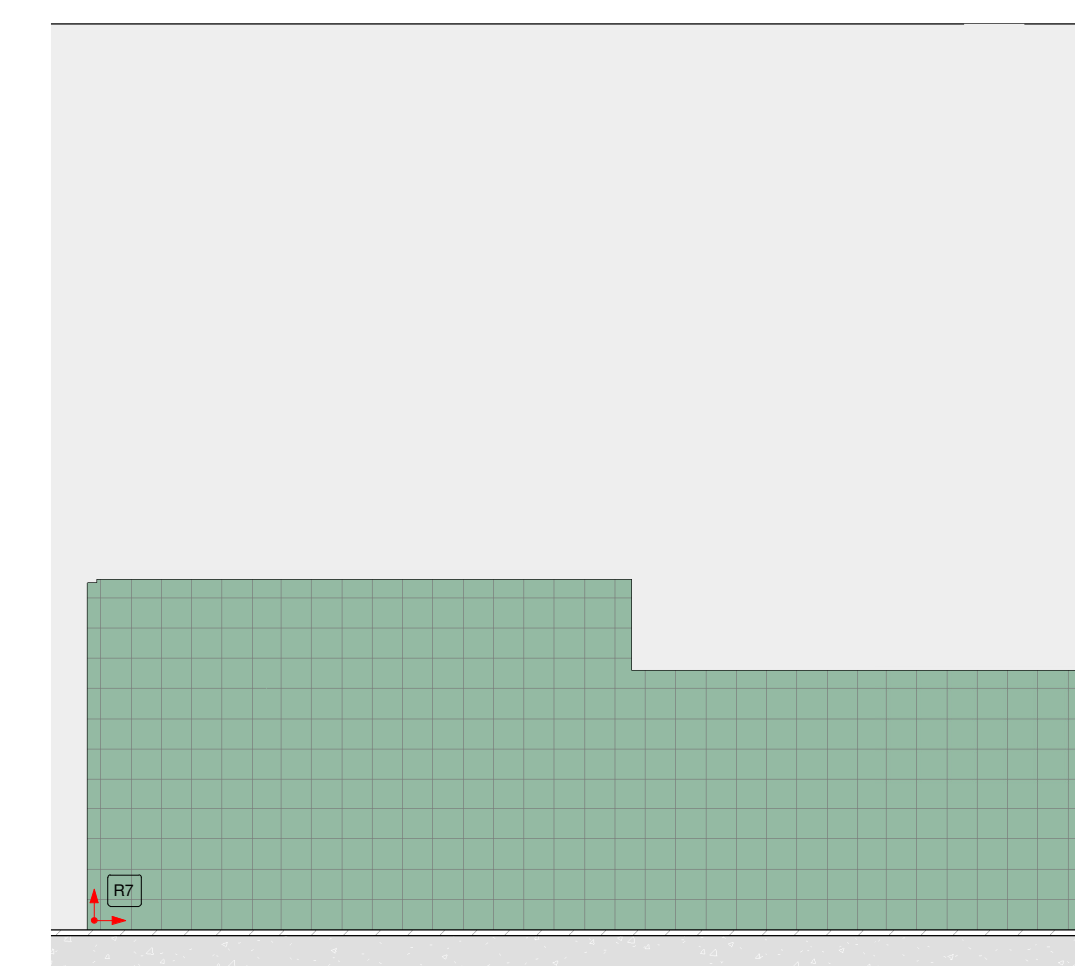

14 VISTA 1 - RECEPÇÃO
1:25

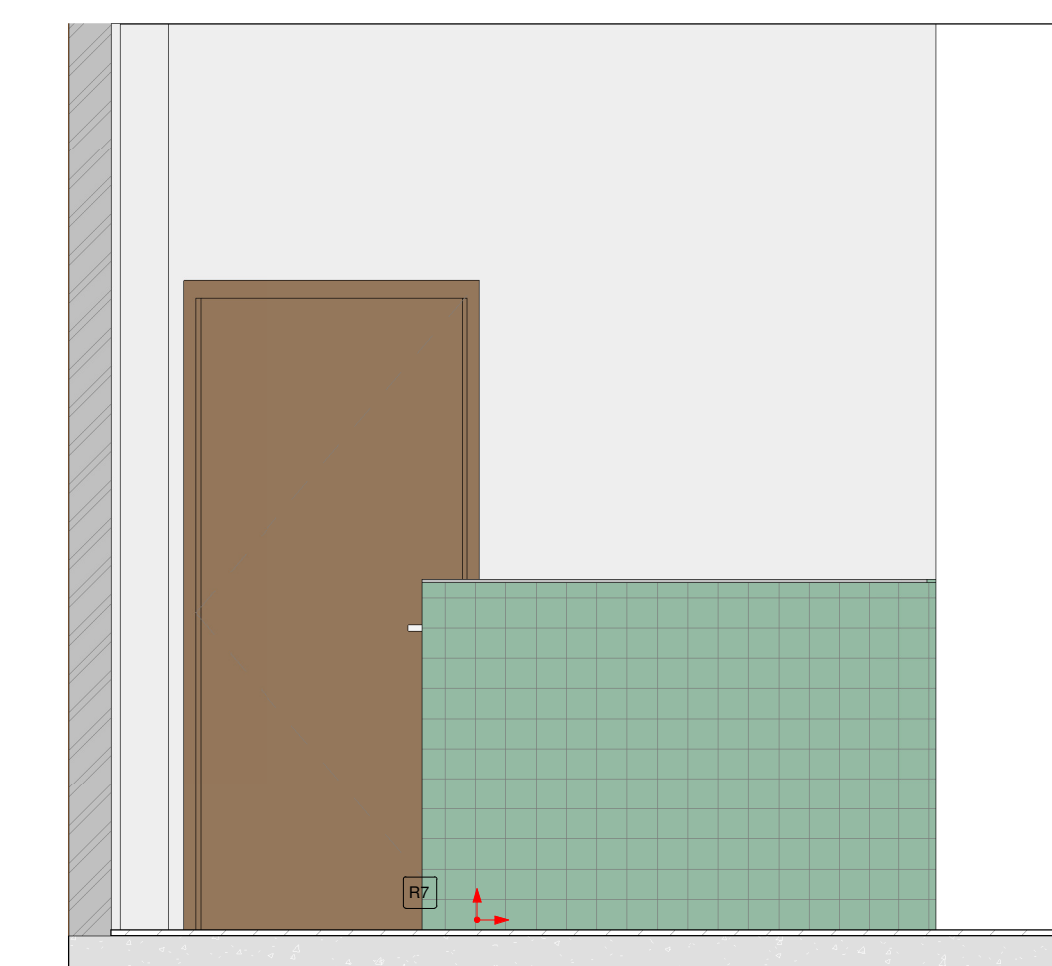

15 VISTA 2 - RECEPÇÃO
1:25

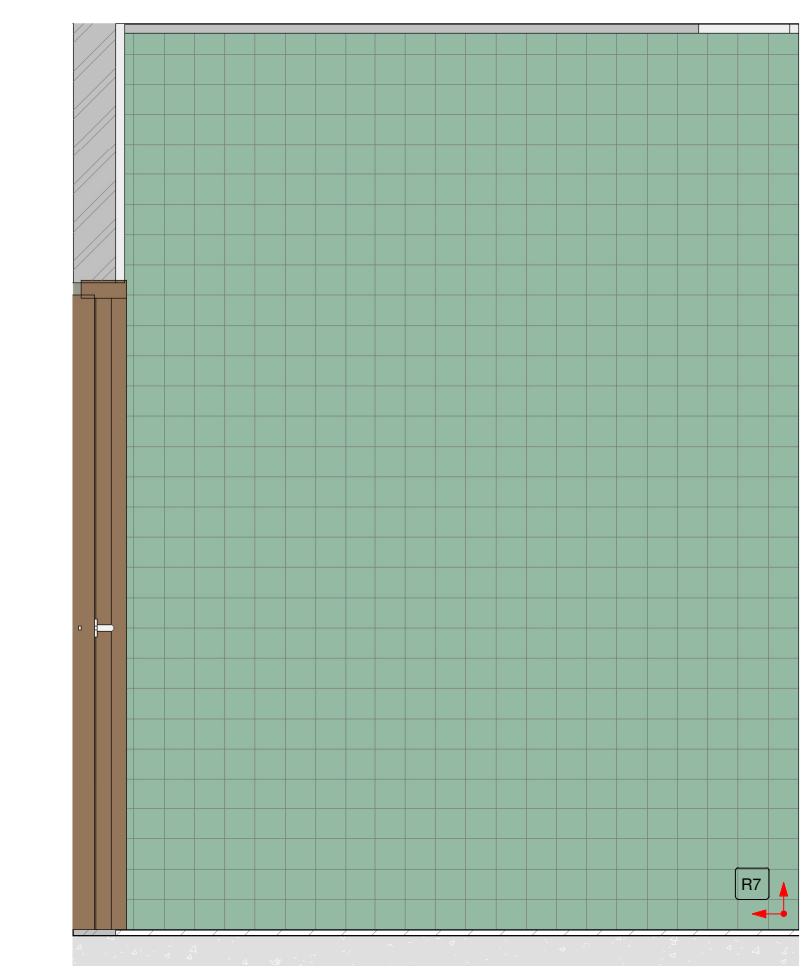

16 VISTA 1 - ESPERA PÚBLICO
1:25

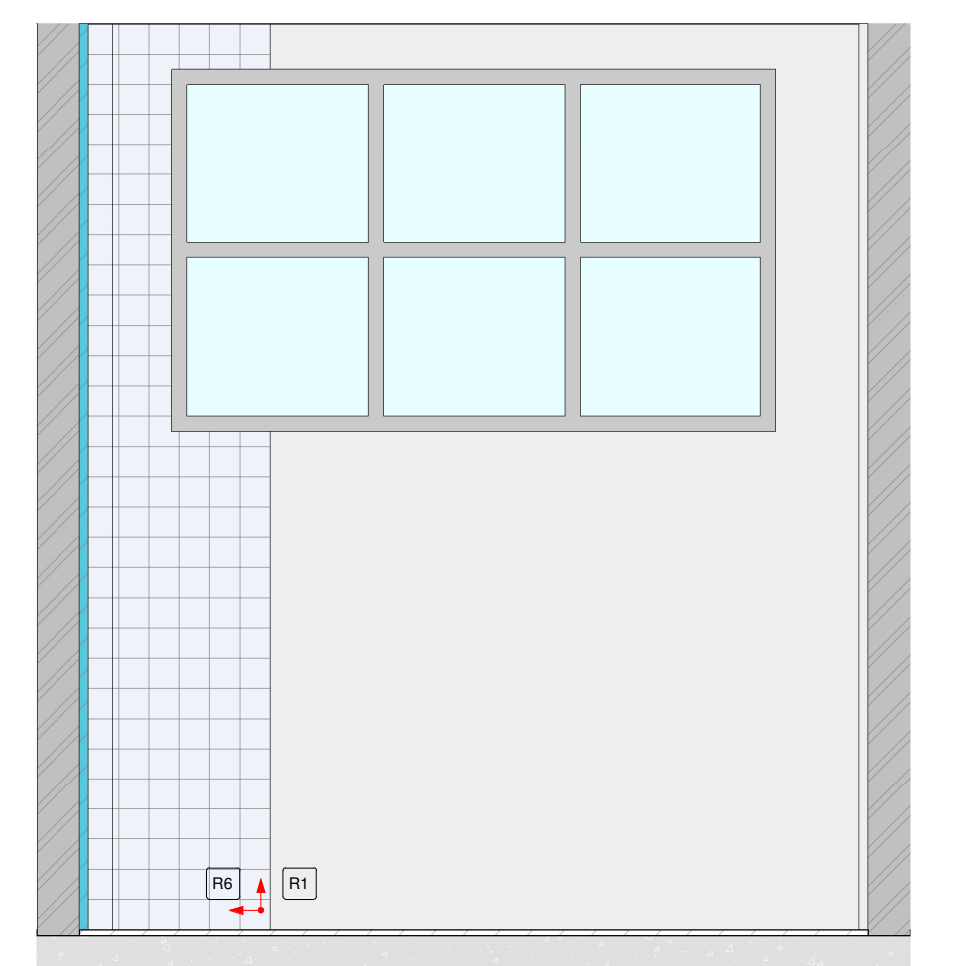

17 VISTA 2 - SALA DE GESSO
1:25

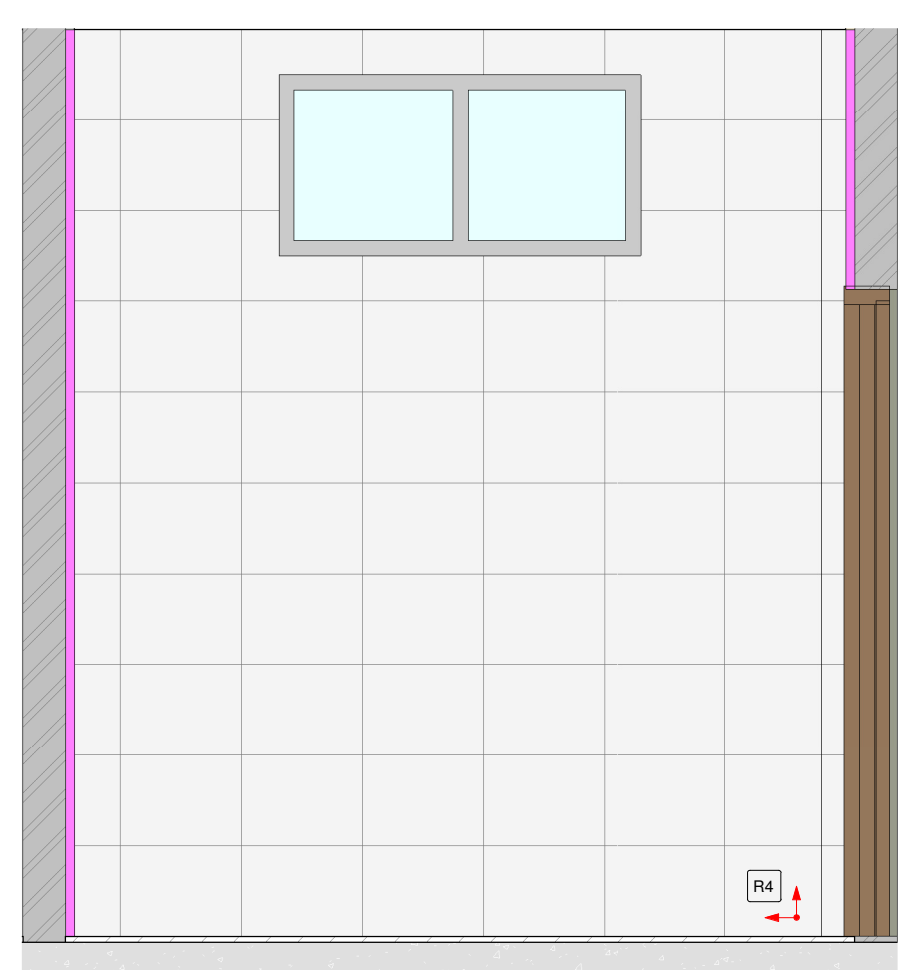

18 VISTA 1 - I.S RADIOLOGIA
1:25

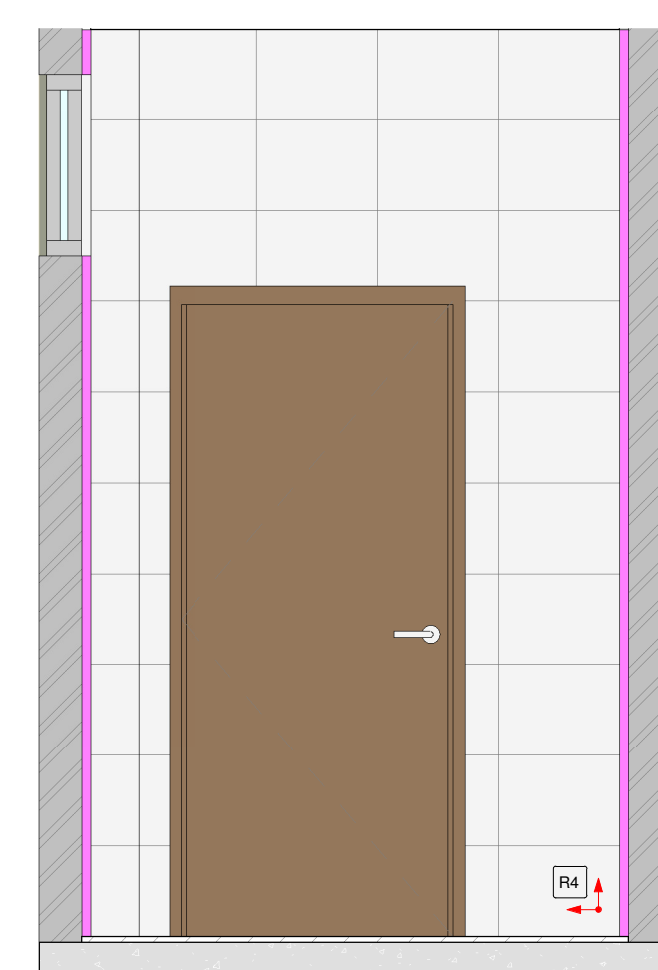

19 VISTA 2 - I.S RADIOLOGIA
1:25

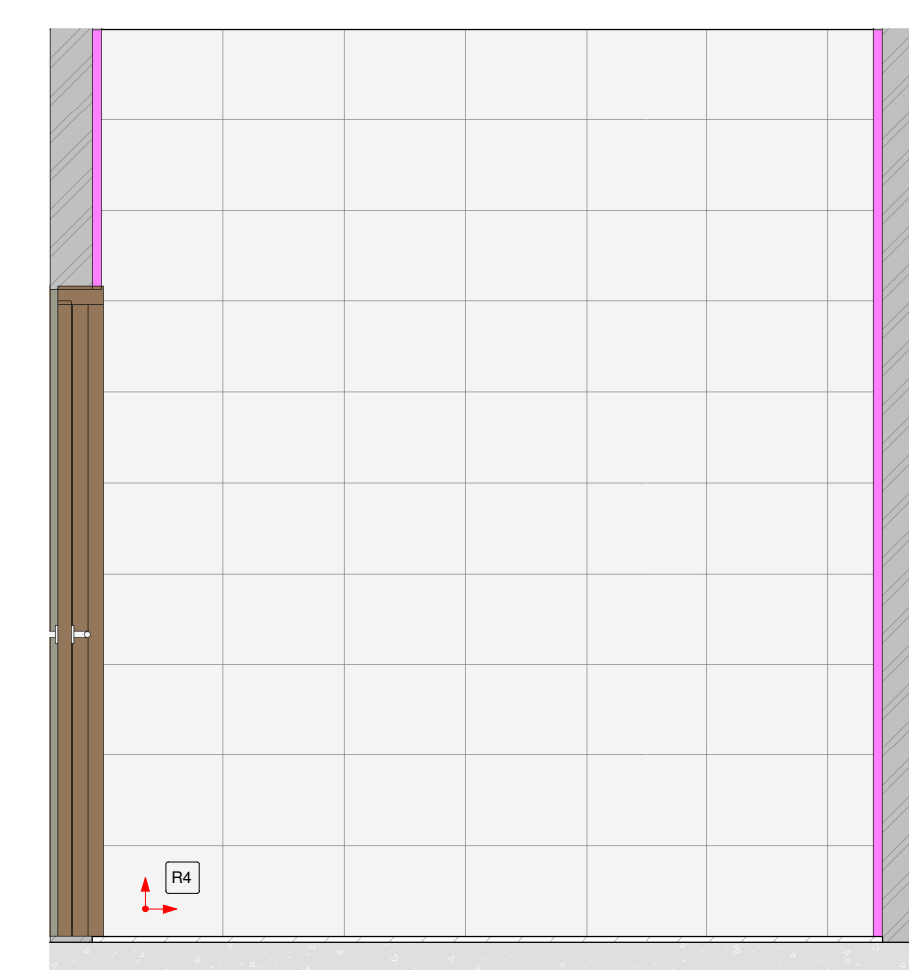

20 VISTA 3 - I.S RADIOLOGIA
1:25



21 VISTA 4 - I.S RADIOLOGIA
1:25

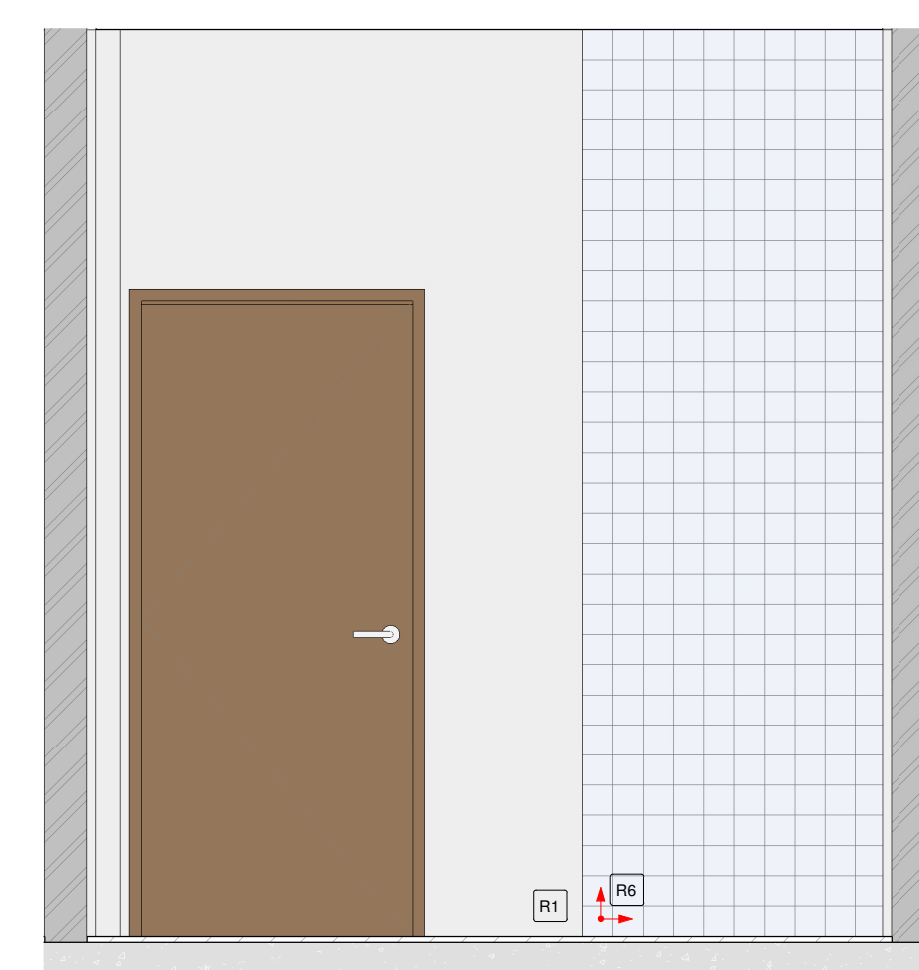

22 VISTA 1 - CONSULTÓRIO 2
1:25

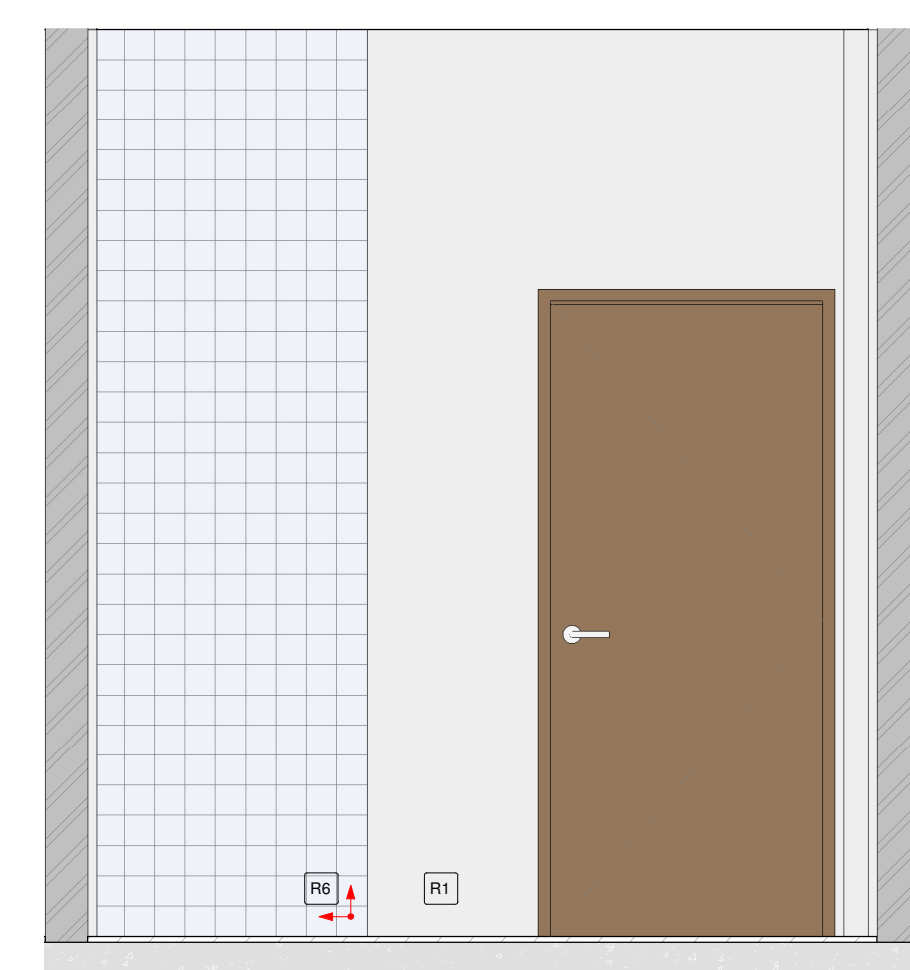

23 VISTA 1 - CONSULTÓRIO 3
1:25

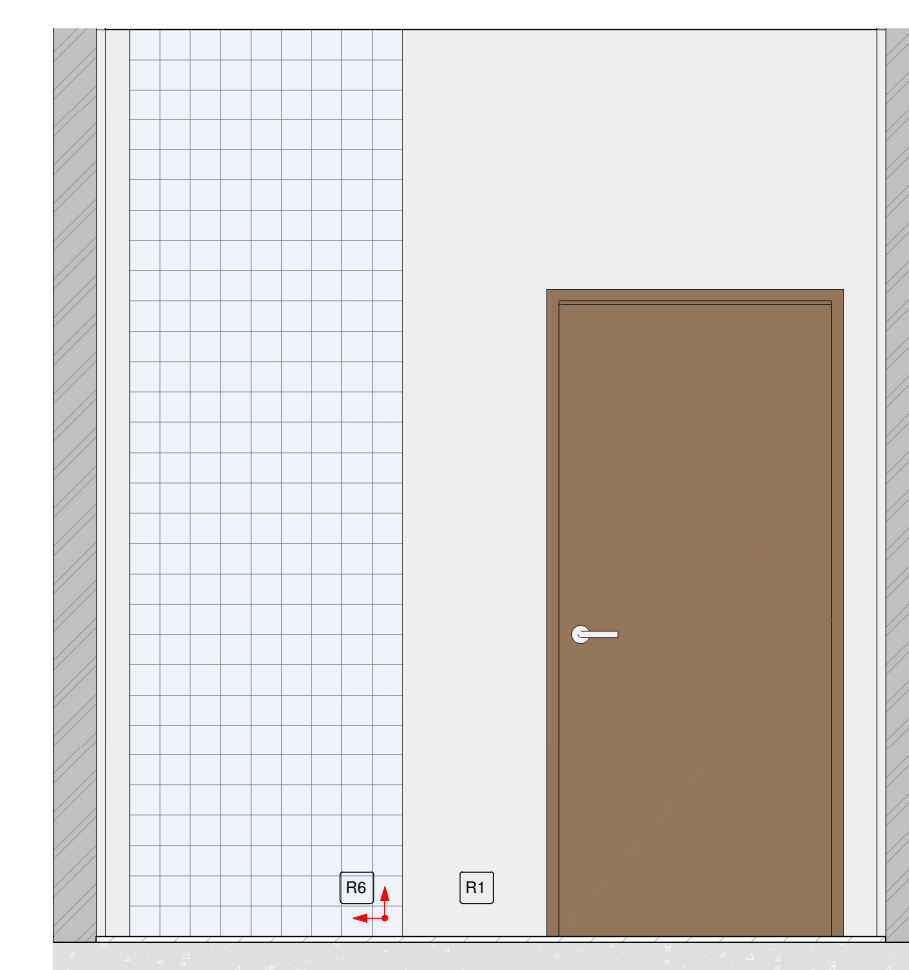

24 VISTA 1 - CONSULTÓRIO GINECOLÓGICO
1:25

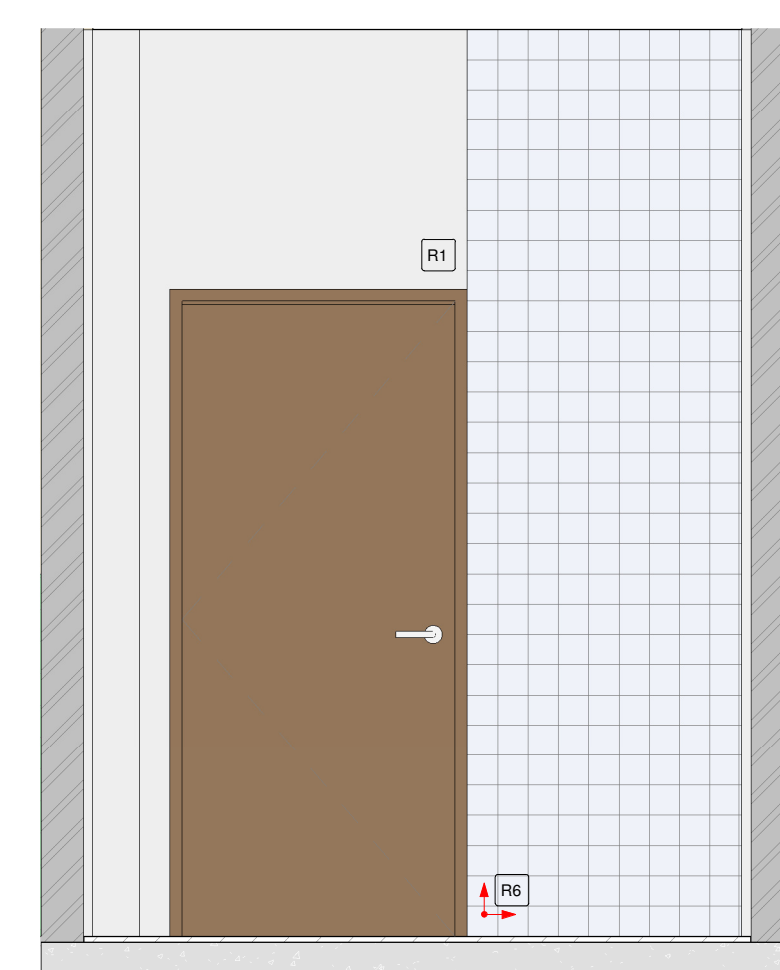

25 VISTA 1 - CONSULTÓRIO 4
1:25

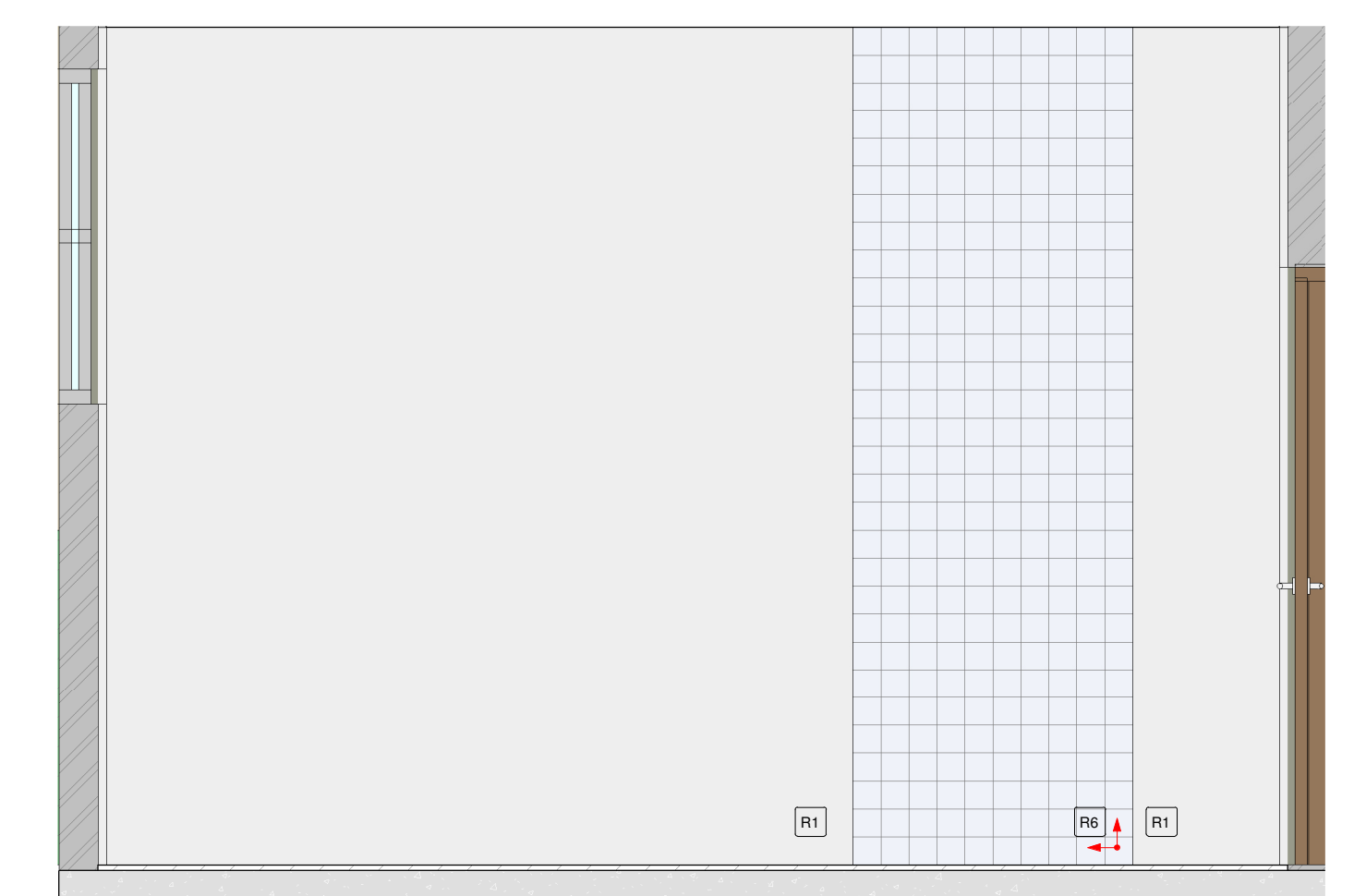

26 VISTA 3 - SALA DE GESSO
1:25

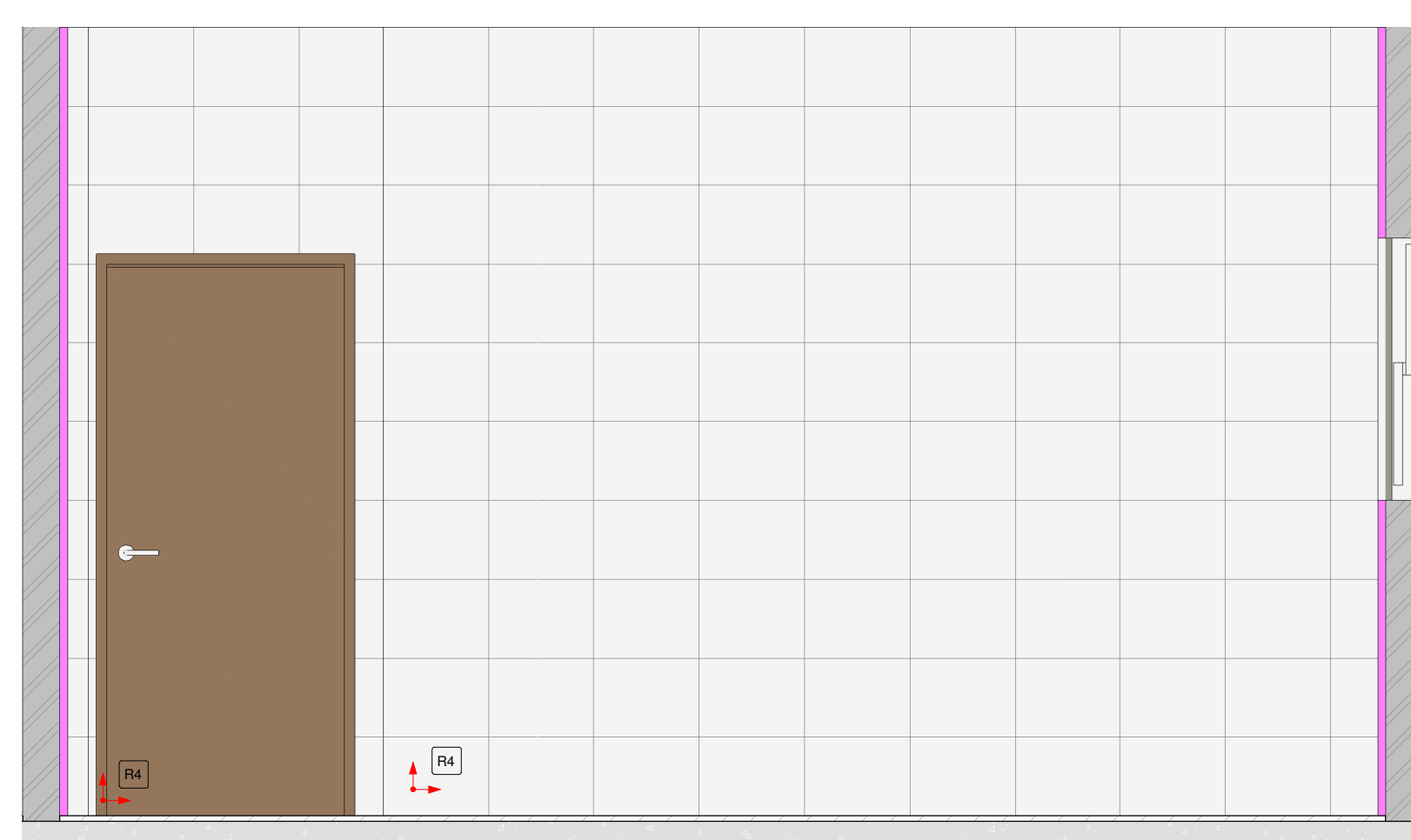

27 VISTA 1 - EXPURGO
1:25

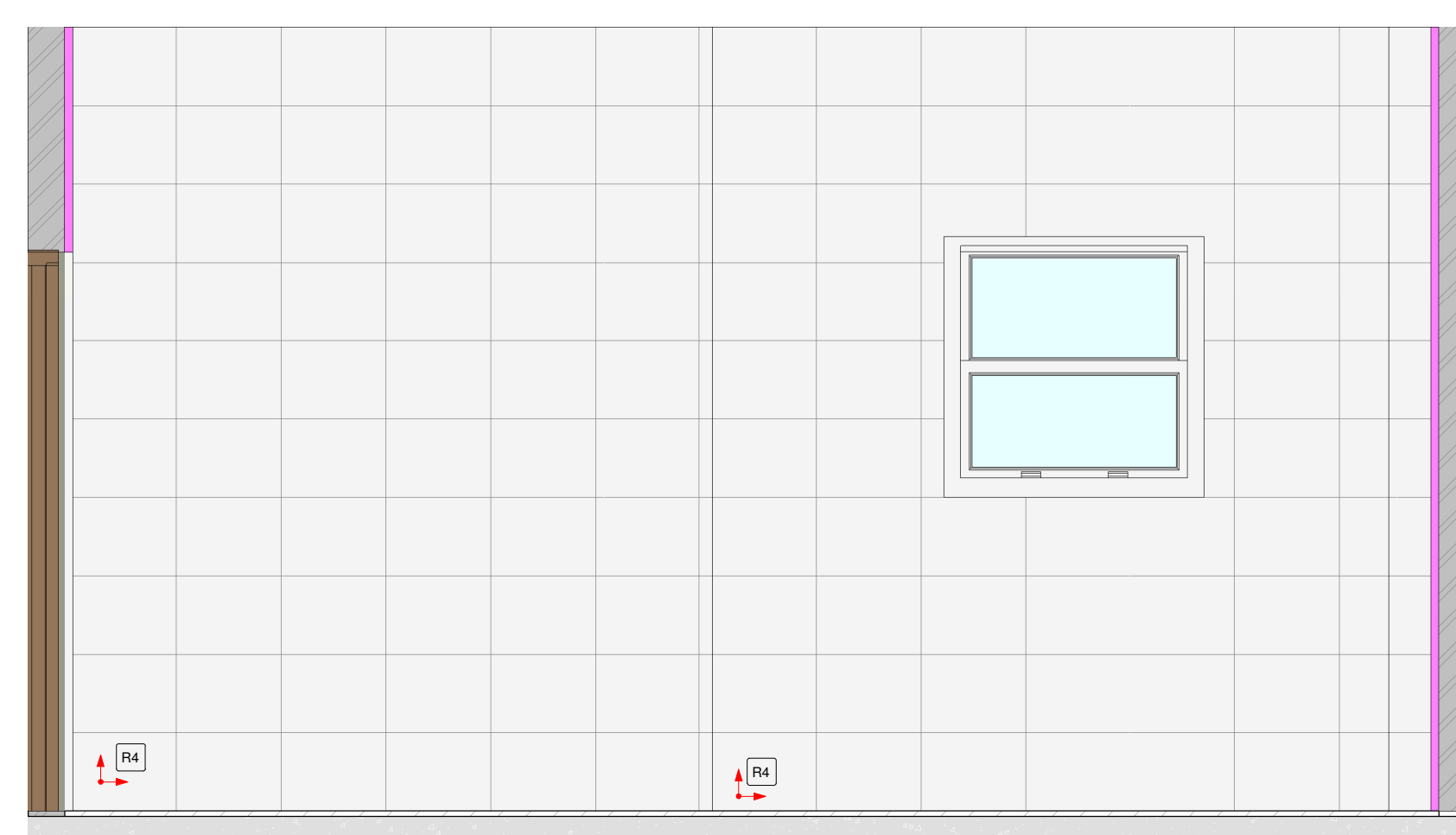

28 VISTA 2 - EXPURGO
1:25

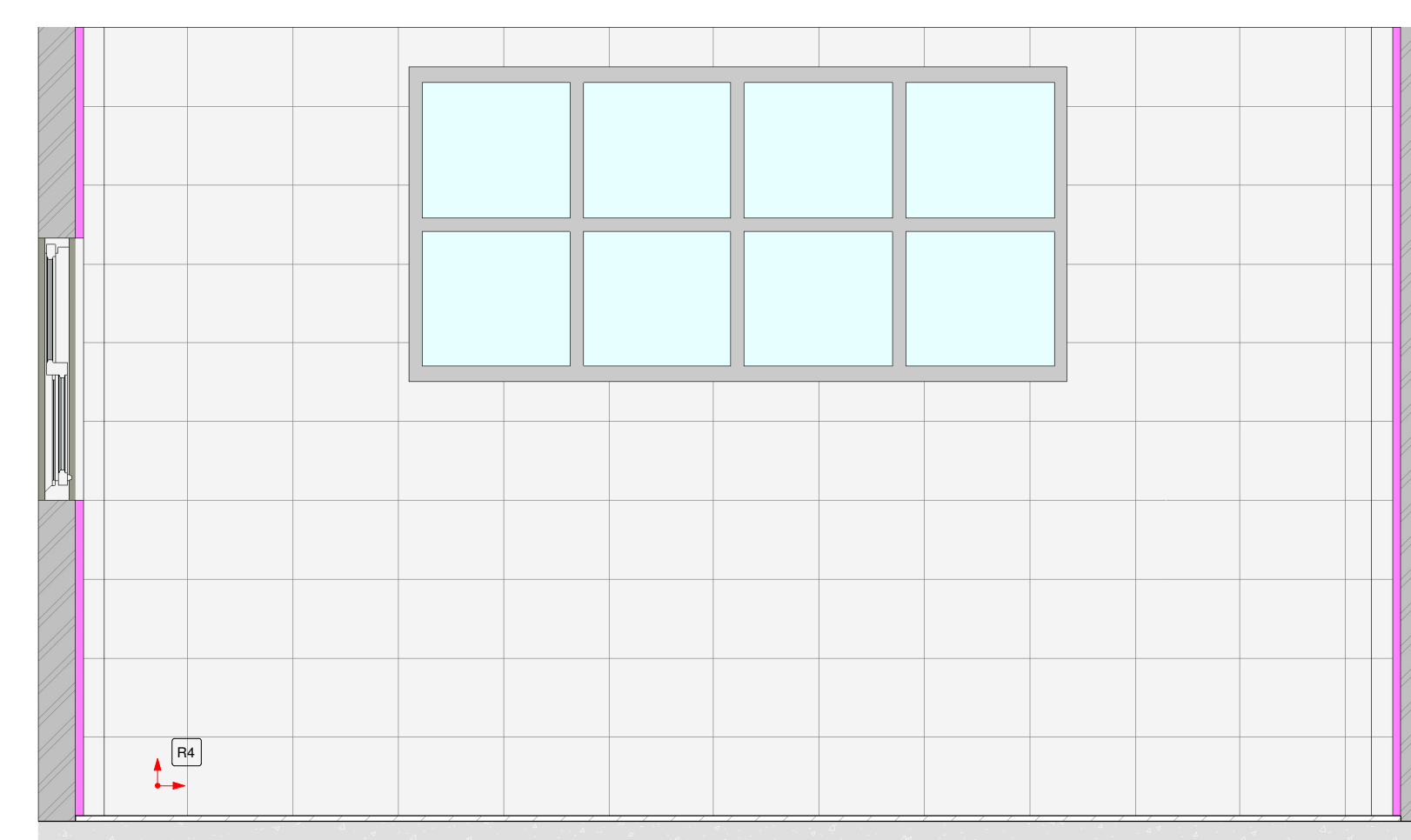

29 VISTA 3 - EXPURGO
1:25

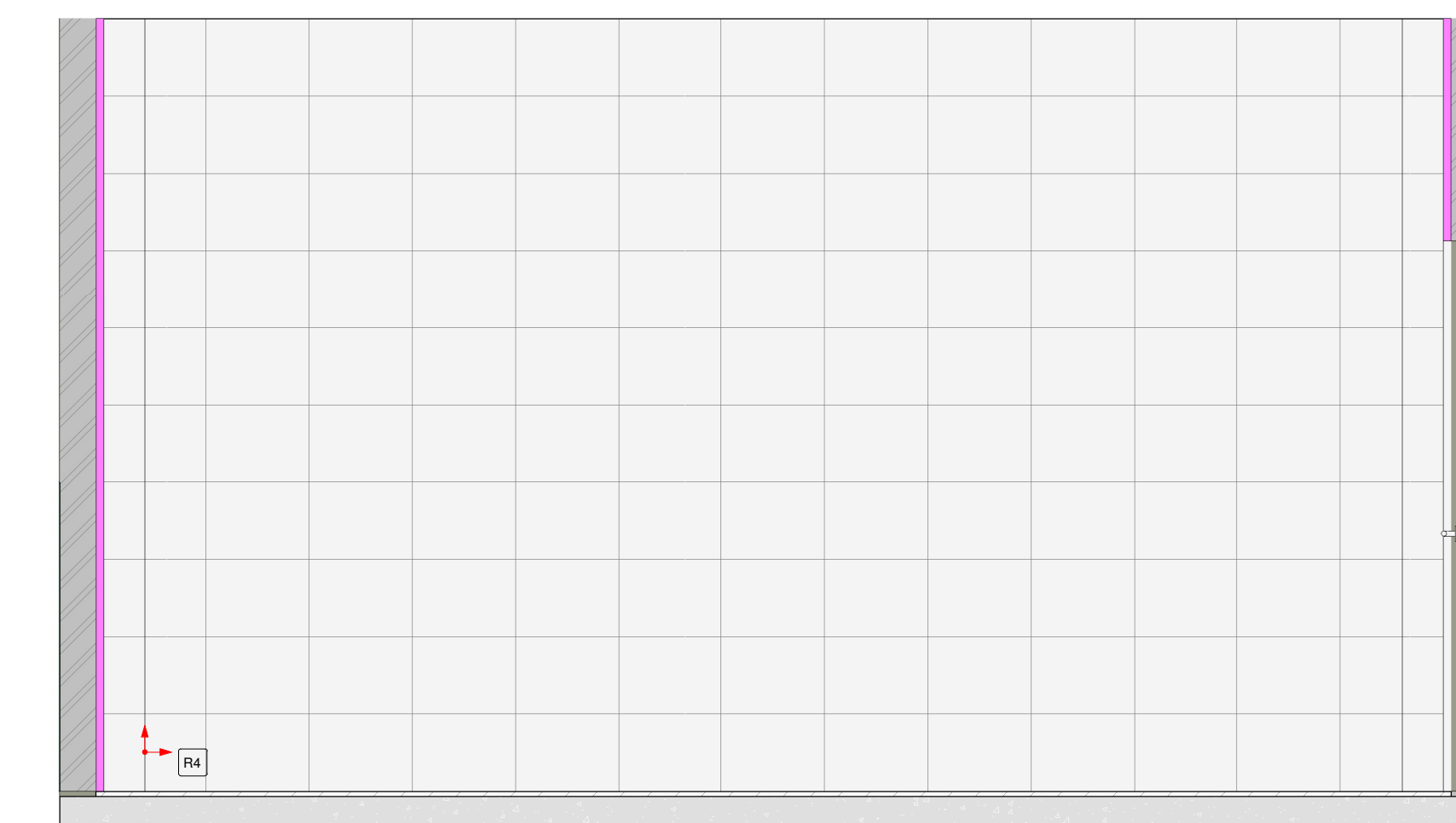

30 VISTA 4 - EXPURGO
1:25

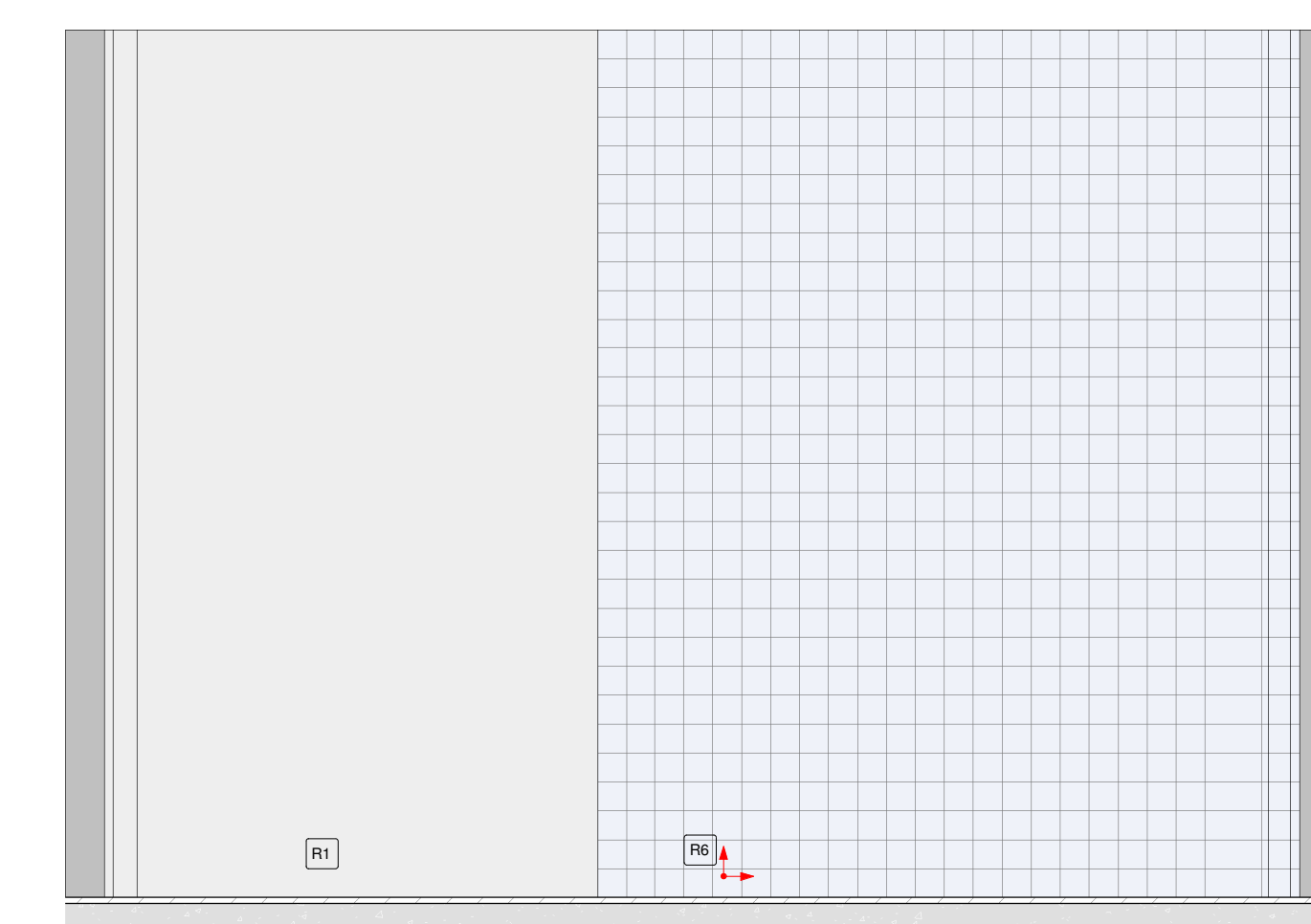

31 VISTA 1 - SERVIÇOS E ENFERMAGEM
1:25

NOTAS:
-MEDIDAS DE NÍVEIS EM METROS;
-VERIFICAR DETALHES CONSTRUTIVOS PERTINENTES NO MEMORIAL DESCRITIVO;
-AS ALTERAÇÕES NESTE PROJETO SOMENTE COM AUTORIZAÇÃO EXPRESSA DA FISCALIZAÇÃO E DA EMPRESA PROJETISTA.

REFERÊNCIAS:
-PLANILHA DE QUANTITATIVOS;
-MEMORIAL DESCRITIVO E ESPECIFICAÇÕES.

REVISÃO	DATA	DESCRIÇÃO	RESP.
REV. 01	20/06/2023	CONFORME SOLICITAÇÃO DA VIOLÊNCIA SANITÁRIA	DAC
REV. 02	28/06/2023	CONFORME SOLICITAÇÃO DA VIOLÊNCIA SANITÁRIA	DAC
REV. 03	31/01/2023	EMISSÃO INICIAL	DAC



PROJETO: **DAC Engenharia**
Rua Miguel Viana, nº 81, Sala 12
Bairro Morro Oito
CEP: 37500-000 - Itaipava / MG
Tel: (35) 3625-8844
www.dacengenharia.com.br

RESPONSÁVEL TÉCNICO:
ENGR. CIVIL FLÁVIA BARBOSA - CREA MG-167.842/D

PROJETO	ESCALA	REVISÃO
31/01/2023	INDICADA	REV.02

CONSTRUÇÃO DA UNIDADE DE PRONTO ATENDIMENTO

PROJETO: RUA PIRANGUINHO, B. SÃO JOÃO
POUSO ALEGRE - MINAS GERAIS

MEMORIAL DESCRITIVO

ARQUITETÔNICO

EXECUTIVO

08/15